

# Table of Contents

Explanation of Street Naming and Addressing.....	2
Diagonal and Other Roads with Names Not Conforming to the Illinois Rural Referencing System .....	3
County Map .....	6
Township Map .....	7
Fire Protection Districts Map .....	8
<b><u>Maps of Townships</u></b>	
Bethel .....	9
Blandinsville .....	10
Bushnell .....	11
Chalmers .....	12
Colchester .....	13
Eldorado .....	14
Emmet .....	15
Hire .....	16
Industry .....	17
Lamoine .....	18
Macomb .....	19
Mound .....	20
New Salem .....	21
Prairie City .....	22
Sciota .....	23
Scotland .....	24
Tennessee .....	25
Walnut Grove.....	26
<b><u>Maps of Cities and Towns</u></b>	
Adair .....	27
Bardolph .....	28
Blandinsville .....	29
Bushnell.....	30
Colchester .....	31
Good Hope .....	32
Industry.....	33
Macomb.....	34
Macomb, Spring View Hills Subdivision .....	35
Macomb, WIU Campus .....	36
Prairie City .....	37
Sciota .....	38
Tennessee .....	39
<b><u>Maps of Subdivisions</u></b>	
Emmet Township Subdivisons.....	40
Georgetown Subdivision .....	41
Meadowbrook Subdivision .....	42
Scotland Glen Subdivision .....	43

# Explanation of Street Naming and Addressing

Previously all rural intersections in McDonough County were identified with markers that are based upon the Illinois Rural Reference System (IRRS). Thus all streets were named with a number followed by either the letter N or the letter E. Streets that run north-south were given a number based upon their distance from the west edge of the county and the letter E. For example, a street designated 1450E would be 14 and 1/2 miles from the West edge of the county. East-west trending roads were similarly named, except that the letter N was appended to the road name. A road designated 1450N would be 14 and 1/2 miles from the south edge of the county. This naming scheme, however, is not acceptable to the U.S. Postal Service. In order to conform to postal regulations, a slight modification of this naming scheme was made. Most roads in the county have numbers for names and those numbers will be their old IRRS designations. In addition, the following three modifications were made: the post-directional letter (N or E) is now a pre-directional letter and must be separated from the street name by space; "th" was appended to the numbered street names; streets that run north-south (designated with the pre-directional E) are called **streets**, streets that run east-west (designated with the pre-directional N) are called **roads**. For example, there is a N 1400th Street and an E 1400th Road.

Streets that do not have the same IRRS designation at both ends (hereafter called diagonal streets) were **not** named using a variant of the IRRS. Instead these streets were given either generic names or are called US highways or Illinois highways, where appropriate. As much as possible, the generic names follow the convention of beginning with the first two or three letters of the township in which the roads originate. For example, Empire Road is located in Emmet Township. Furthermore these streets are all called roads. The county has several state and US highways and these are named highways along with their appropriate state or federal designation, such as, US Highway 136 and Illinois Highway 9.

The numbers (addresses) assigned to buildings along all numbered streets (e.g, N 1400th Rd, and E 1400th St) consist of one to five digits. These numbers actually are milage measurements from either the west edge of the county for roads with the pre-directional N or from the south edge of the county for streets with the pre-directional E. The right three digits in an address, that has at least three digits, measure thousands of a mile. (For addresses that have less than three digits, the interpretation is the same, for example, 50 N 300th Road is 50 thousandths (.050) of a mile or 5 hundredths (.05) of a mile from the west county line.) For addresses that have more than four digits, the left one or two digits measure miles. Thus the address 9680 N 800th Road is located 9.680 miles from the southern edge of the county. Each one mile section begins a new rural block. Unlike city blocks which usually increment by 100 for each new block, our rural blocks increment by 1000 for each new block. This method permits up to 1000 addresses per mile.

The diagonal streets use a similar addressing scheme, except that the addressing is not measured from the edges of the county, but from roads that they intersect. In general, if a diagonal road has mostly a south-north orientation, the addressing begins at the intersection at its southern point. If the orientation is mostly west-east, the numbering begins at its most western intersection. The same numbering system also applies to the US and Illinois Highways.

# Diagonal and Other Roads Not Conforming to the IRRS

Prefix	Street Name	Suffix	Township	Section(s)/Places*	
W	Adams	Rd	Emmet	34, 35 (Macomb)*	
	Argyle Park	Rd	Colchester	1	
	Armstrong	Rd	Emmet	27	
	Ash	St	New Salem	Adair	
	Bacon Woods	CrI	Chalmers	12	
	Bacon Woods	Dr	Chalmers	12	
	Bacon Woods	Ln	Chalmers	12	
	Beaumont	Rd	Bethel	12	
	Beaver	Rd	Bethel	15, 22	
	Bedford	Rd	Bethel	18	
	Bellingham	Rd	Bethel	21, 22, 23, 24	
	Benson	Rd	Bethel	31	
	Bergen	Rd	Bethel	31, 32, 29	
	Berkeley	Rd	Bethel	29, 20, 19	
	Berlin	Rd	Bethel	8, 17, 20	
	Bermuda	Rd	Bethel	18	
	Blackhawk	Rd	Blandinsville	18	
	Blackburn	Rd	Blandinsville	21, 22	
	Blackfoot	Rd	Blandinsville	6	
	Blackjack	Rd	Blandinsville	23, 14	
	Blairmore	Rd	Blandinsville	30, 29	
	Blueberry	Rd	Blandinsville	16, 17	
	Bluebird	Rd	Blandinsville	12, 13	
	Bluejay	Rd	Blandinsville	8	
	Candy	Ln	Scotland	5, 6, 7, 8 (Macomb)*	
	Champaign	Rd	Colchester	30, 31, 32	
	Charlotte	Rd	Chalmers	33, 34	
	Cherokee	Rd	Chalmers	11, 12, 1	
	Cherry	St	New Salem	Adair	
	Chesapeake	Rd	Chalmers	32, 33	
	Cheyenne	Rd	Chalmers	4	
	Chicago	Rd	Chalmers	4	
	China	Rd	Chalmers	13, 12	
	Choctaw	Rd	Chalmers	32, 29	
	Christian	Rd	Chalmers	4	
	N	Coal	Rd	Colchester	12, 1
		Colorado	Rd	Colchester	5
		Colt	Rd	Colchester	18
		Comanche	Rd	Colchester	21
		Comstock	Rd	Colchester	23
Constitution		Rd	Colchester	13, 14	
Cook		Rd	Colchester	18	
Cottonwood		Dr	Emmet	35	
Deere	Rd	Chalmers	2 (Macomb)*		

	Elizabeth	Rd	Eldorado	26, 25
	Elk	Rd	Eldorado	24
	Elm	St	New Salem	Adair
	Elmira	Rd	Eldorado	23, 25
	Ember	Rd	Emmet	24
	Emblem	Rd	Emmet	9, 4
	Emerald	Rd	Emmet	6
	Emerson	Rd	Emmet	11
	Emily	Rd	Sciota	4, 33
	Emma	Rd	Emmet	30
	Emmy	Rd	Emmet	22
	Emory	Rd	Emmet	27, 22
	Flag	Rd	Emmet	28 (Flint Hills)*
	Flax	Rd	Emmet	28 (Flint Hills)*
	Flint	Rd	Emmet	28 (Flint Hills)*
	Grandview	Rd	Emmet	27
	Hill	Rd	Hire	19
	Hillcrest	Rd	Hire	3
	Holly	St	New Salem	Adair
	IL Highway 41		Mound / Prairie City	33 / 2
	IL Highway 61		Lamoine / Tennessee	7 / 19
	IL Highway 9		Blandinsville / Bushnell	31 / 24
	IL Highway 9 and 41		Bushnell	34, 23
	IL Highway 95		Mound	22, 23, 24
	Ina	Rd	Industry	33, 34, 27
	Inca	Rd	Industry / Scotland	5 / 32
	Independence	Rd	Industry / Scotland	3 / 34
	Indian	Rd	Industry / Scotland	4 / 33
	Indian Hollow	Rd	Industry	17
	Indiana	Rd	Industry	14
	Indigo	Rd	Industry	16
	International	Rd	Industry	32, 29
	Invention	Rd	Industry	5, 4
	Inverness	Rd	Industry	26
W	Jackson	St	Chalmers	35 (Macomb)*
S	Johnson	St	Chalmers	1 (Macomb)*
	Labrador	Rd	Lamoine	9, 4
	Lamar	Rd	Lamoine	35, 26
	Lamb	Rd	Lamoine	Colmar
	Lambert	Rd	Lamoine	29, 20, 21
	Lancaster	Rd	Lamoine	11, 12
	Lancelot	Rd	Lamoine	19
	Lang	Rd	Lamoine	Colmar
	Lansing	Rd	Lamoine	16
	Larado	Rd	Lamoine	30
	Lariat	Rd	Lamoine	35
	Lauderdale	Rd	Lamoine	33, 34
	Lawrence	Rd	Lamoine	13
E	Main	St	Industry	14 (Industry)*
	Mallard	Rd	Macomb	18
	Maple	Av	Scotland	7 (Macomb)*
	Maryland	Rd	Macomb	23, 24
	May	Rd	Macomb	13

E	Mohawk	St	Mound	New Philadelphia
E	Mona	St	Mound	New Philadelphia
	Morse	St	Mound	New Philadelphia
	Murphy	Rd	Bushnell	34 (Bushnell)*
	Oak	St	New Salem	Adair
N	Pearl	Rd	Macomb	30 (Macomb)*
	Pine	St	New Salem	Adair
	Prairie	St	New Salem	Adair
S	Quail Walk	Rd	Emmet	34
S	Quail Walk	Rd	Chalmers	3
	Scot	Rd	Scotland/ New Salem	24 / 30
	Sherry	St	Colchester	18 (Colchester)*
	Spring Lake Park	Rd	Emmet	14
	Telegraphy	Rd	Tennessee	15
	Temple	Rd	Tennessee	17
	Tepee	Rd	Tennessee	29
	Teton	Rd	Tennessee	10, 11, 14
	Tewa	Rd	Tennessee	3
	Texas	Rd	Tennessee	6, 5
	US Highway 136		Tennessee / New Salem	19 / 25
	US Highway 67		Industry / Sciota	34 / 1
	Waco	Rd	Walnut Grove	35
	Walnut	St	New Salem	Adair
	Warren	Rd	Walnut Grove	32
	Wear	Av	Chalmers	1
	Wigwam Hollow	Rd	Emmet	35 (Macomb)*

\* Section numbers refer to one mile square township sections. They indicate the sections that a road passes through, starting with the lowest numbered houses. Place names without a section number mean the road is in a village. A section number and a place name in parentheses e.g., 1 (Macomb), indicates that the road is a continuation of an existing city or town road. Two township names separated by a slash and section numbers separated by a slash designate the starting and ending townships and the starting and ending sections in the respective townships. US and Illinois highways may traverse several townships. Generally, road within incorporated places and subdivision are not included in this list unless they were previously not names or they extend into non-incorporated territory.

# County Map

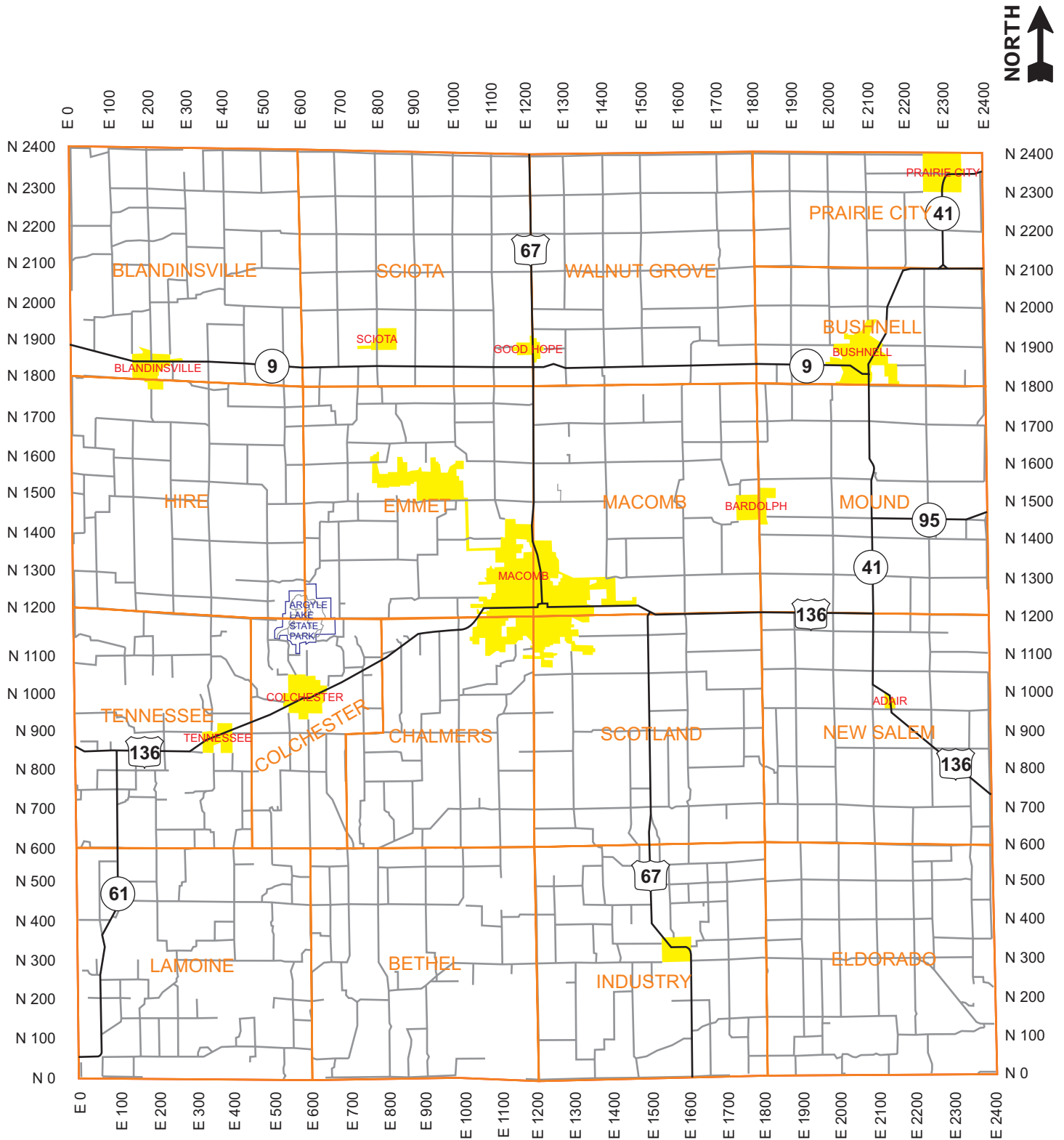

# Township Map



BLANDINSVILLE page 11	SCIOTA page 24	WALNUT GROVE page 27	PRAIRIE CITY page 23
			BUSHNELL page 12
HIRE page 17	EMMET page 16	MACOMB page 20	MOUND page 21
TENNESSEE page 26	COLCHESTER page 14	CHALMERS page 13	SCOTLAND page 25
LAMOINE page 19	BETHEL page 10	INDUSTRY page 18	NEW SALEM page 22
			ELDORADO page 15

# Fire Protection Districts

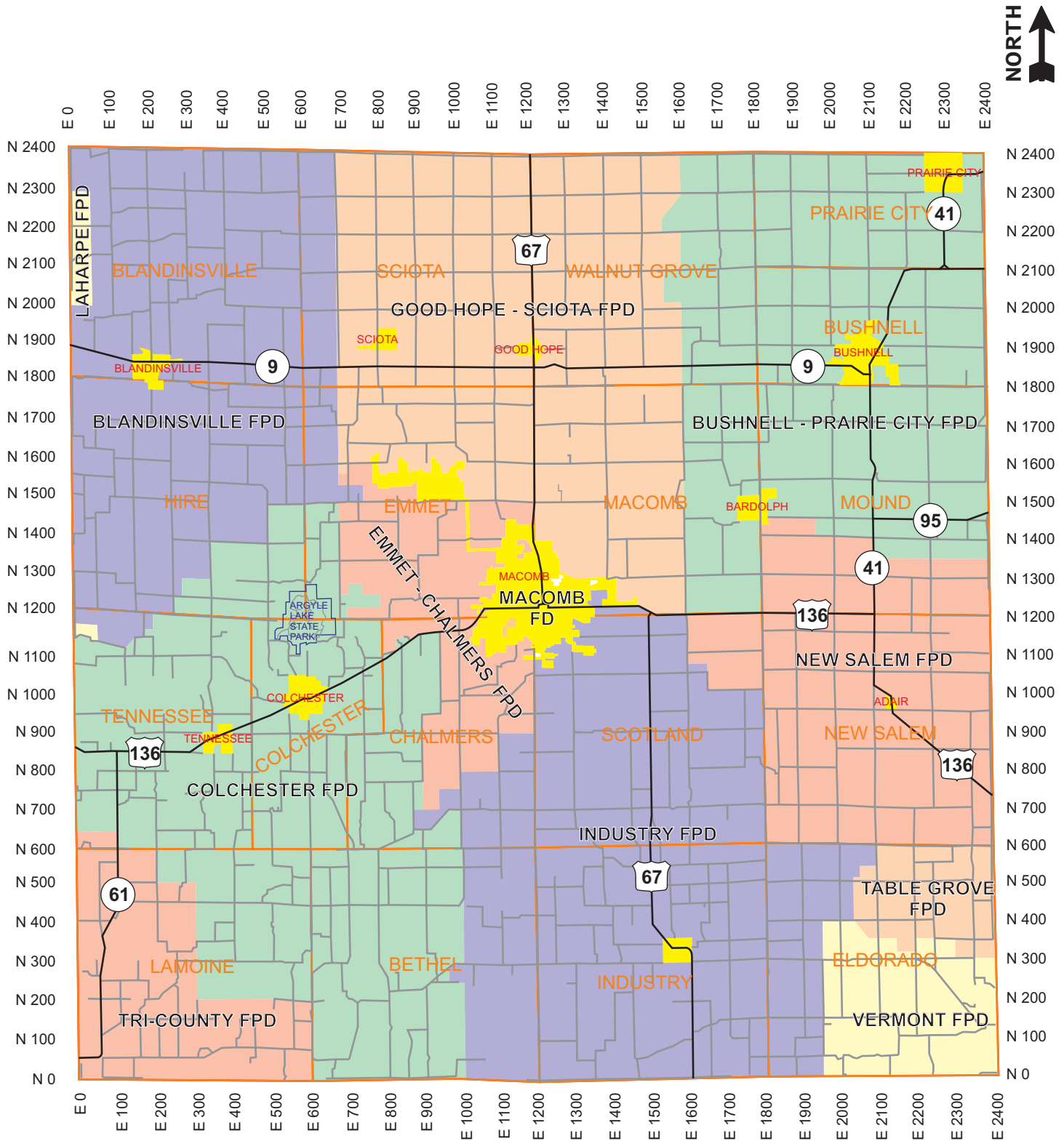





# Bushnell Township

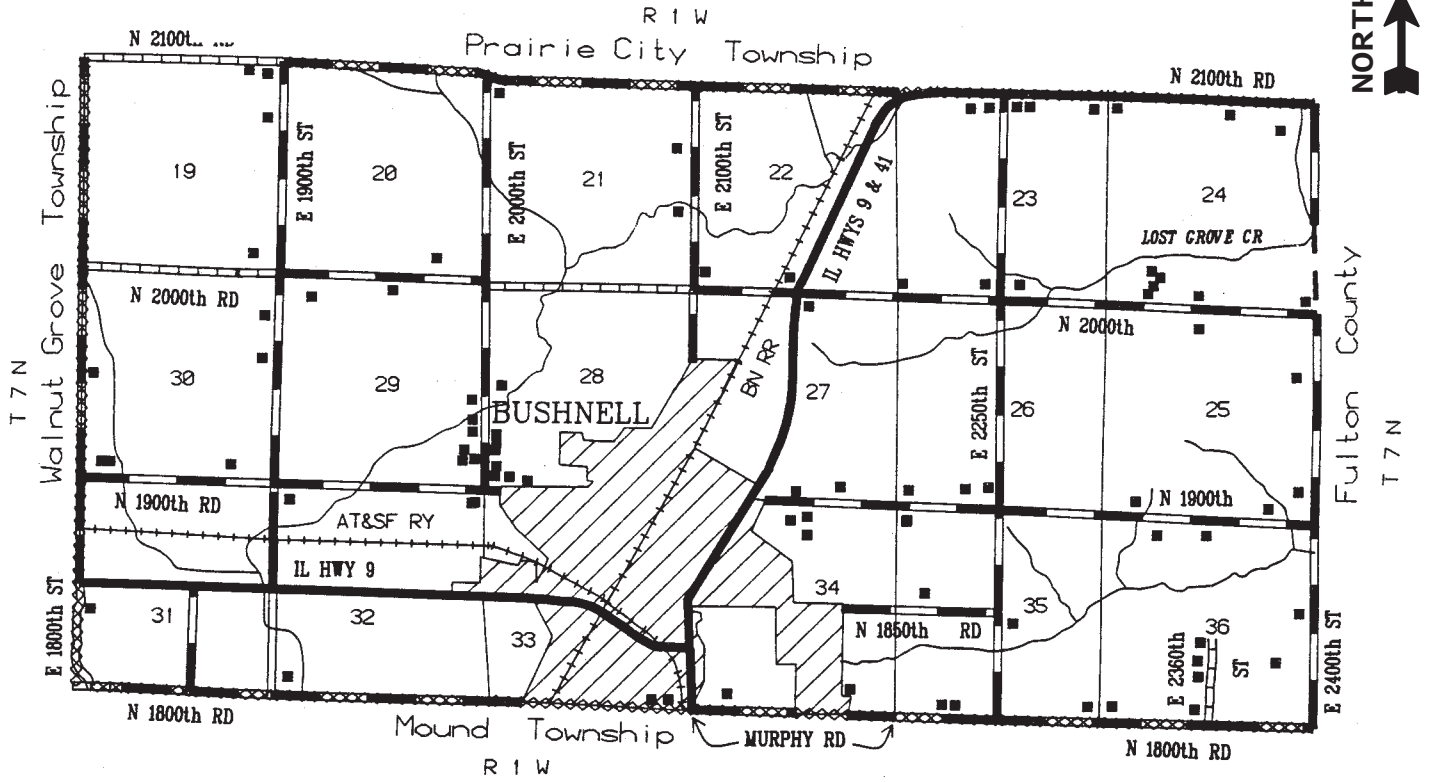

# Chalmers Township

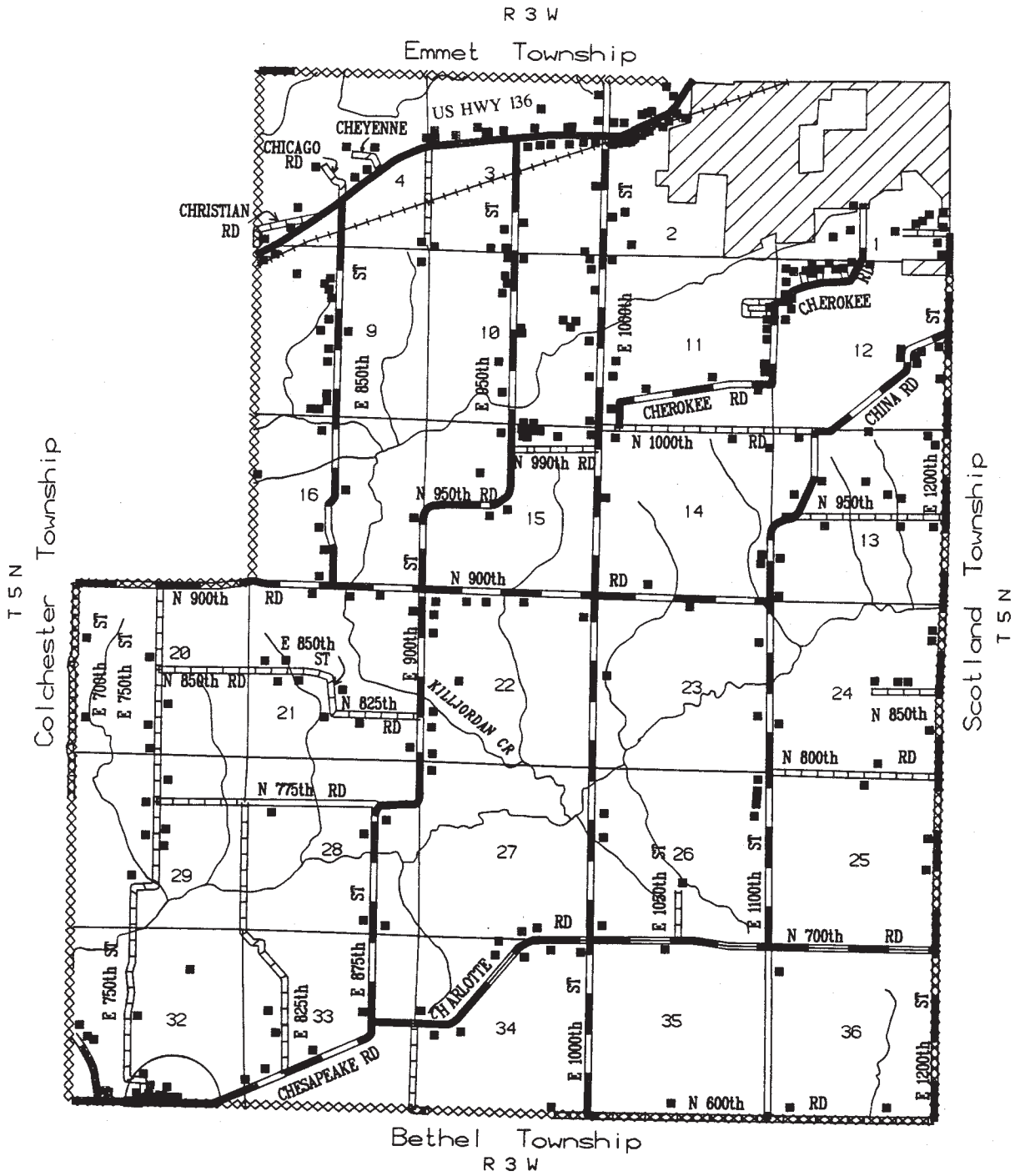

# Colchester Township

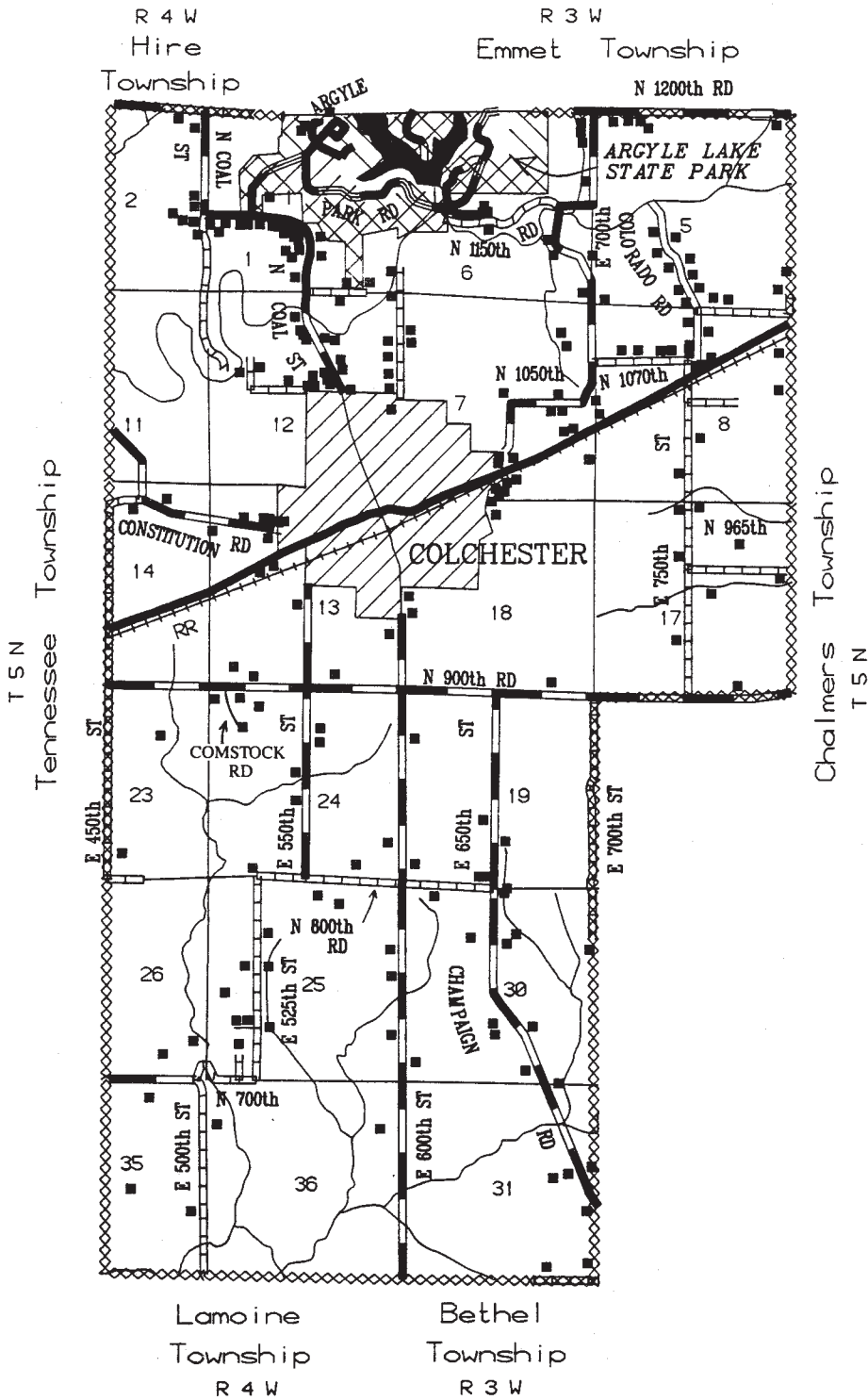



# Emmet Township

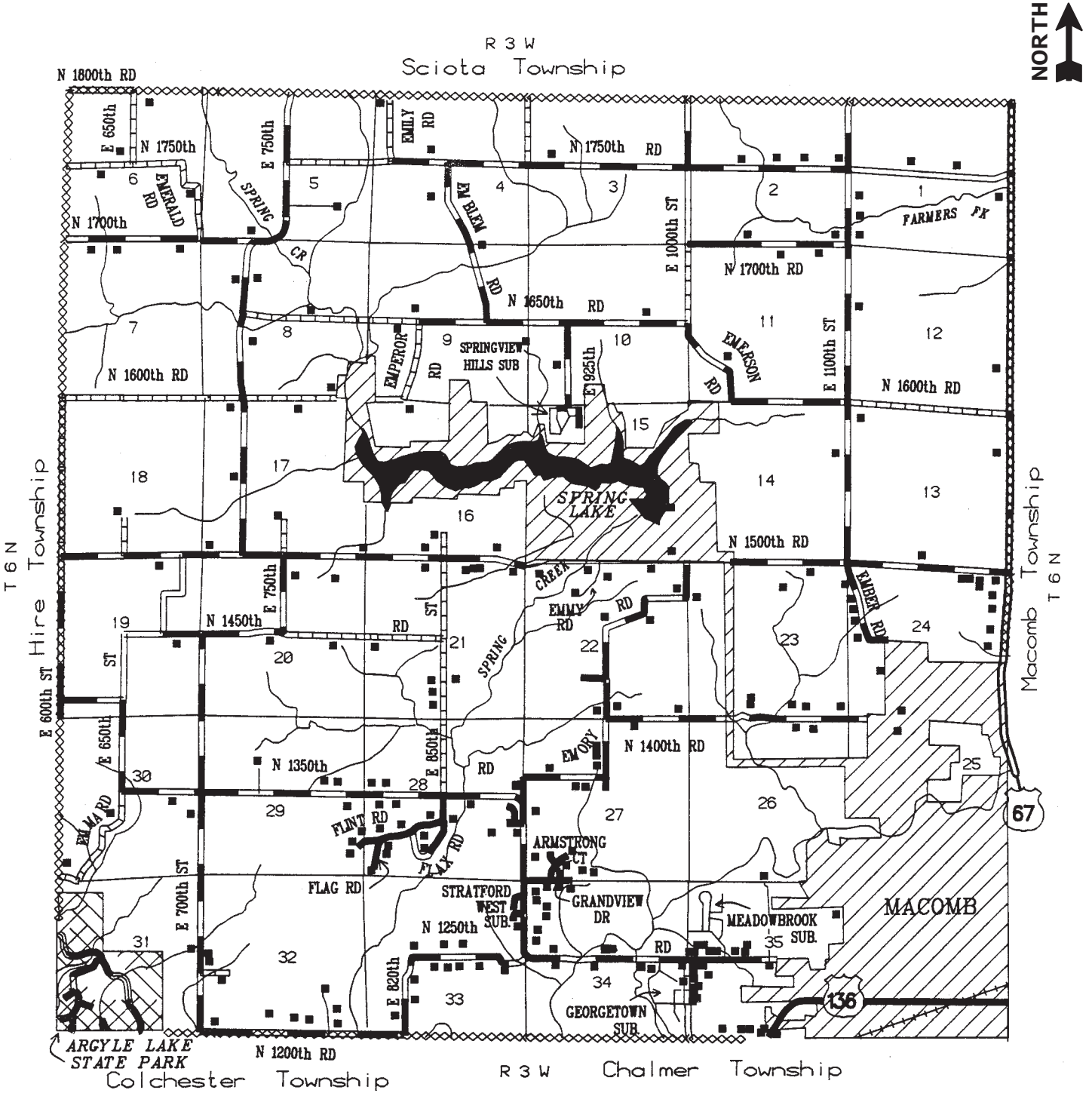

# Hire Township

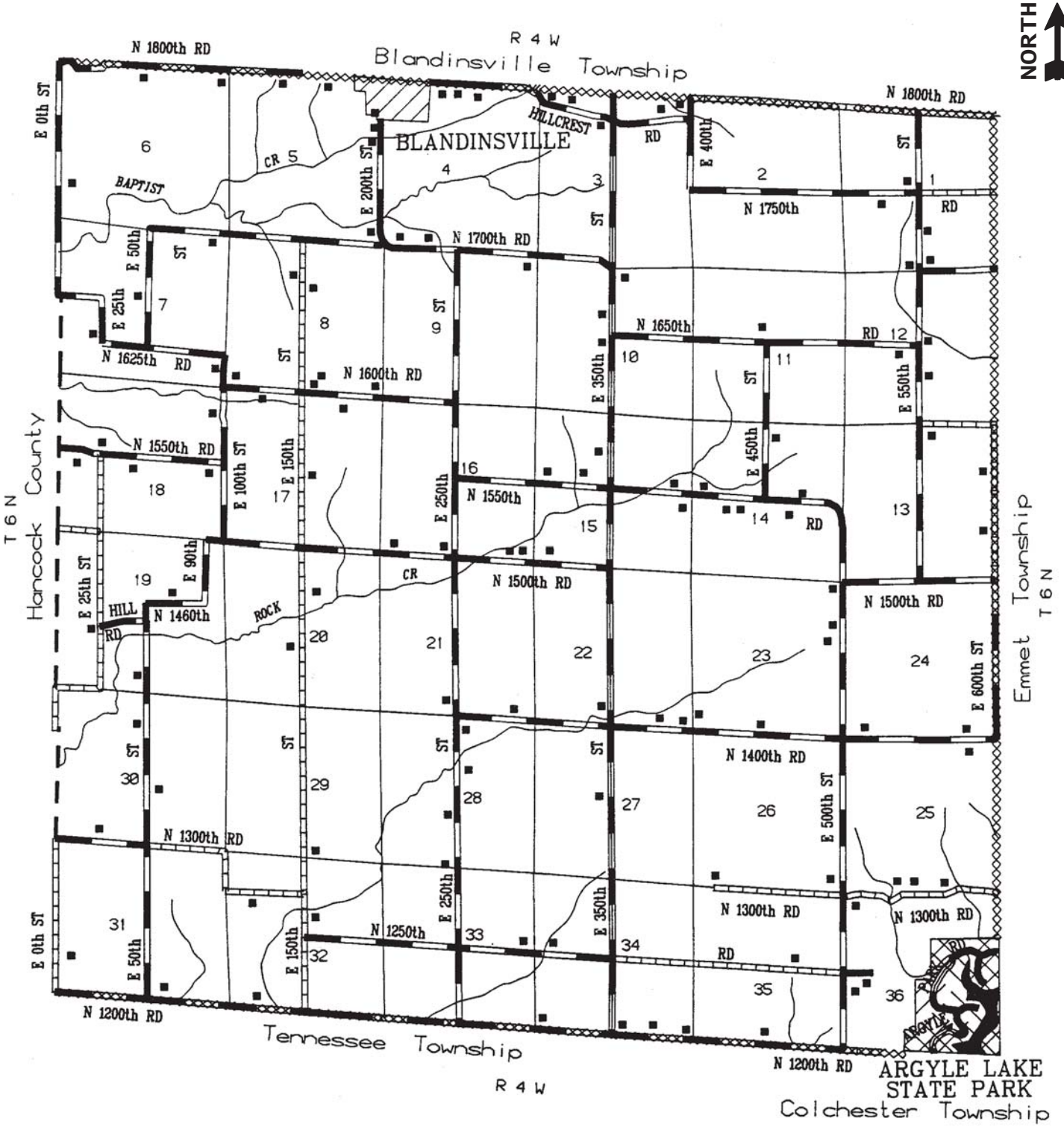

# Industry Township

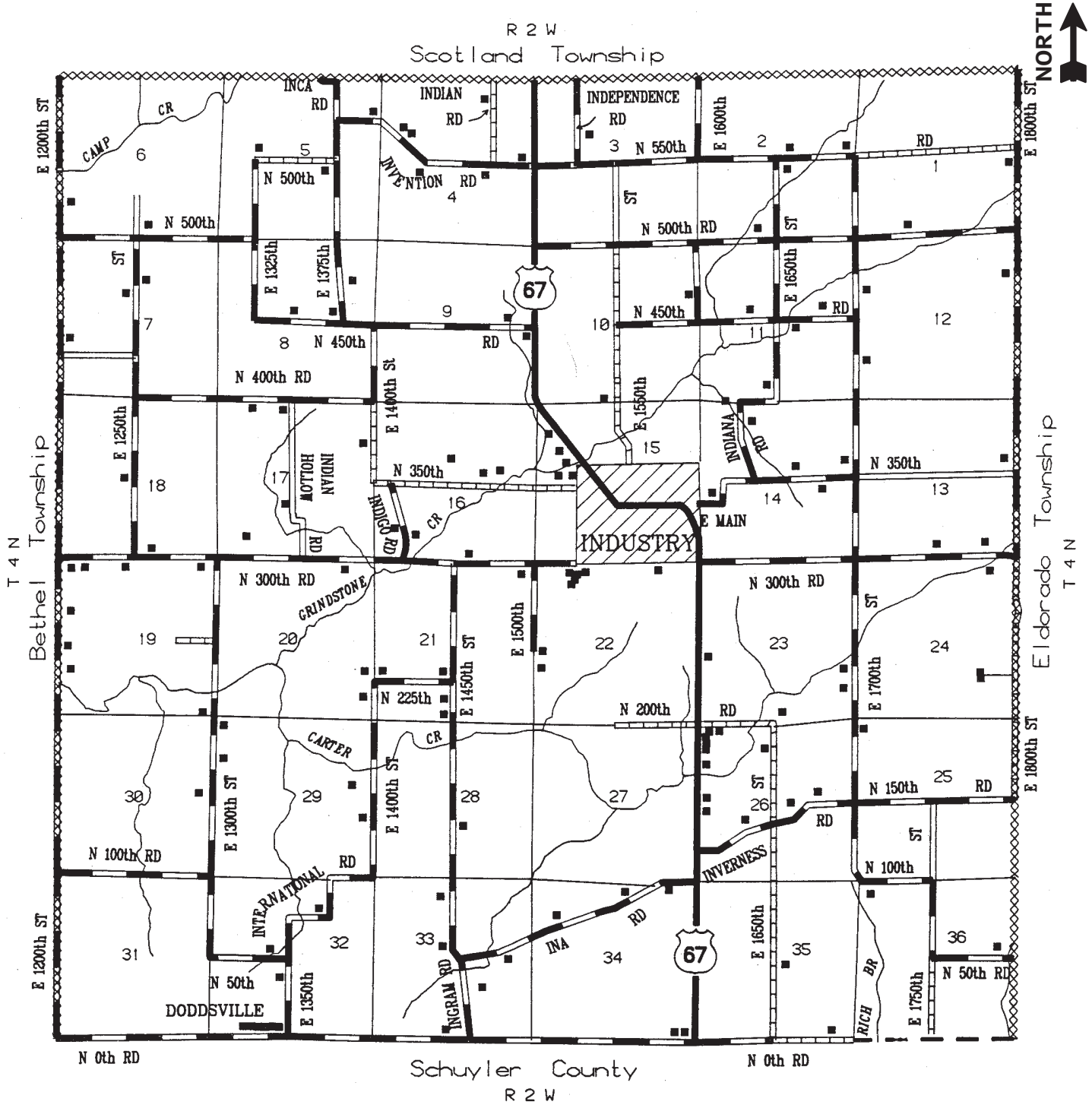



# Macomb Township

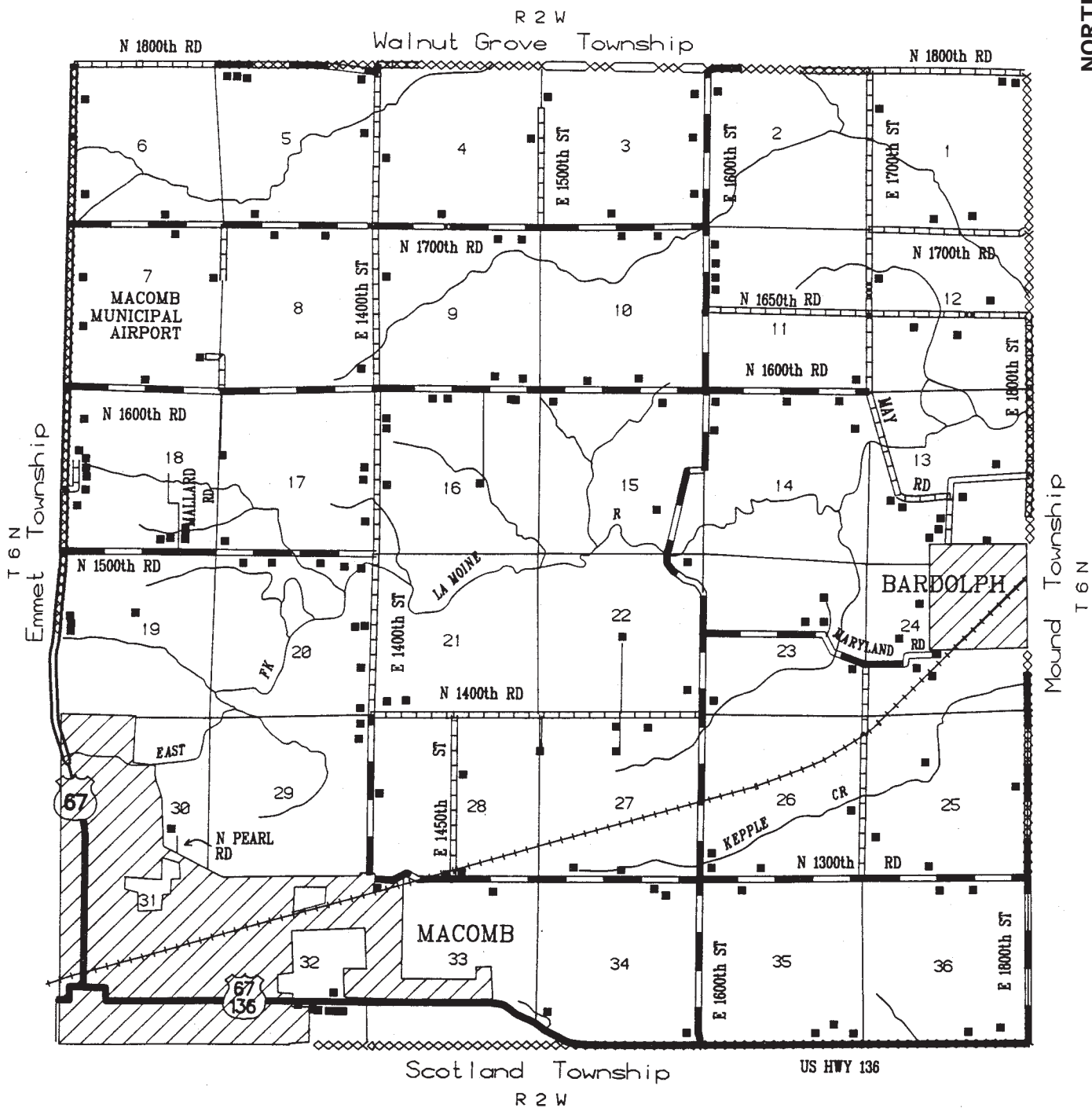

# Mound Township

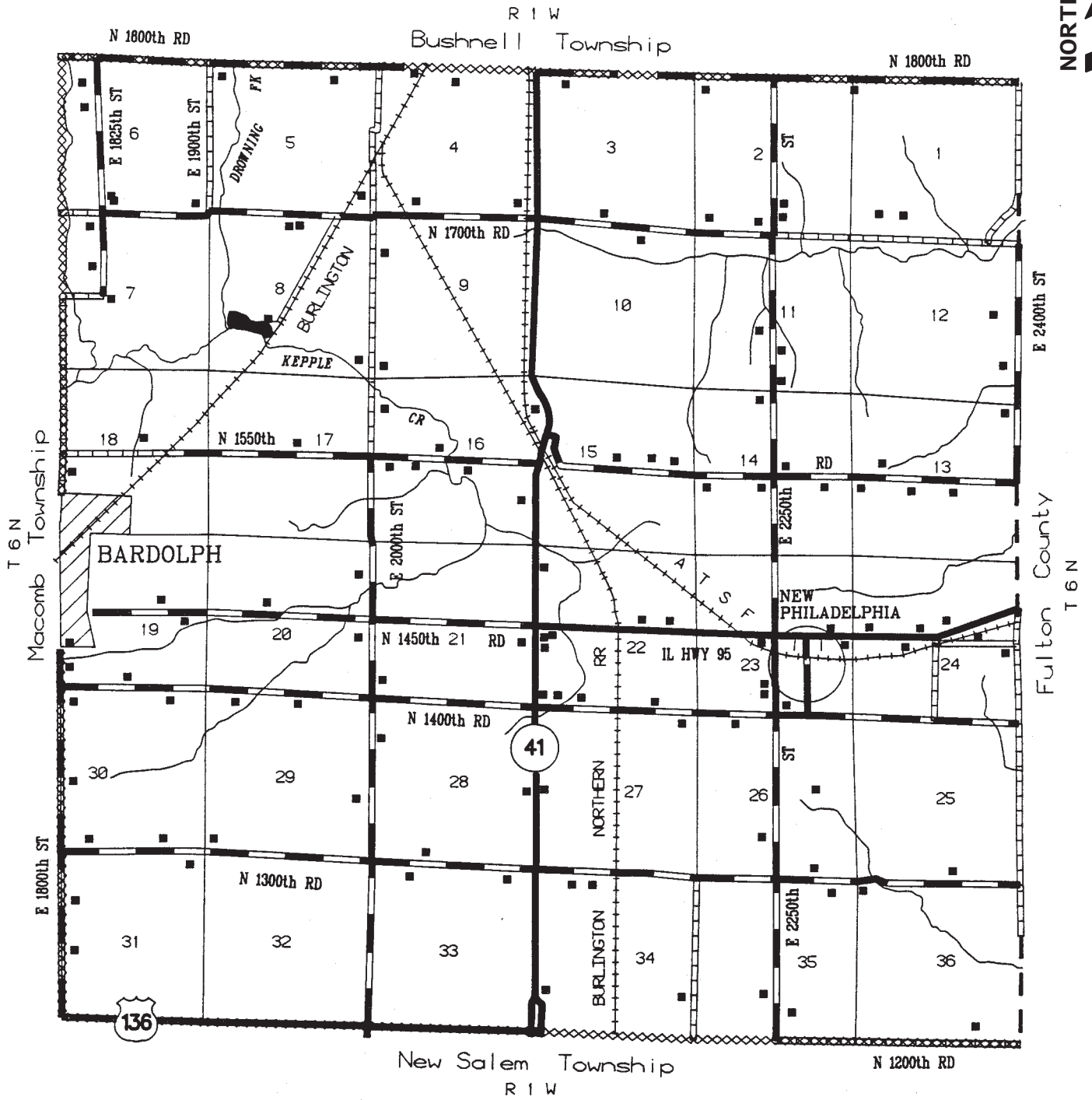

# New Salem Township

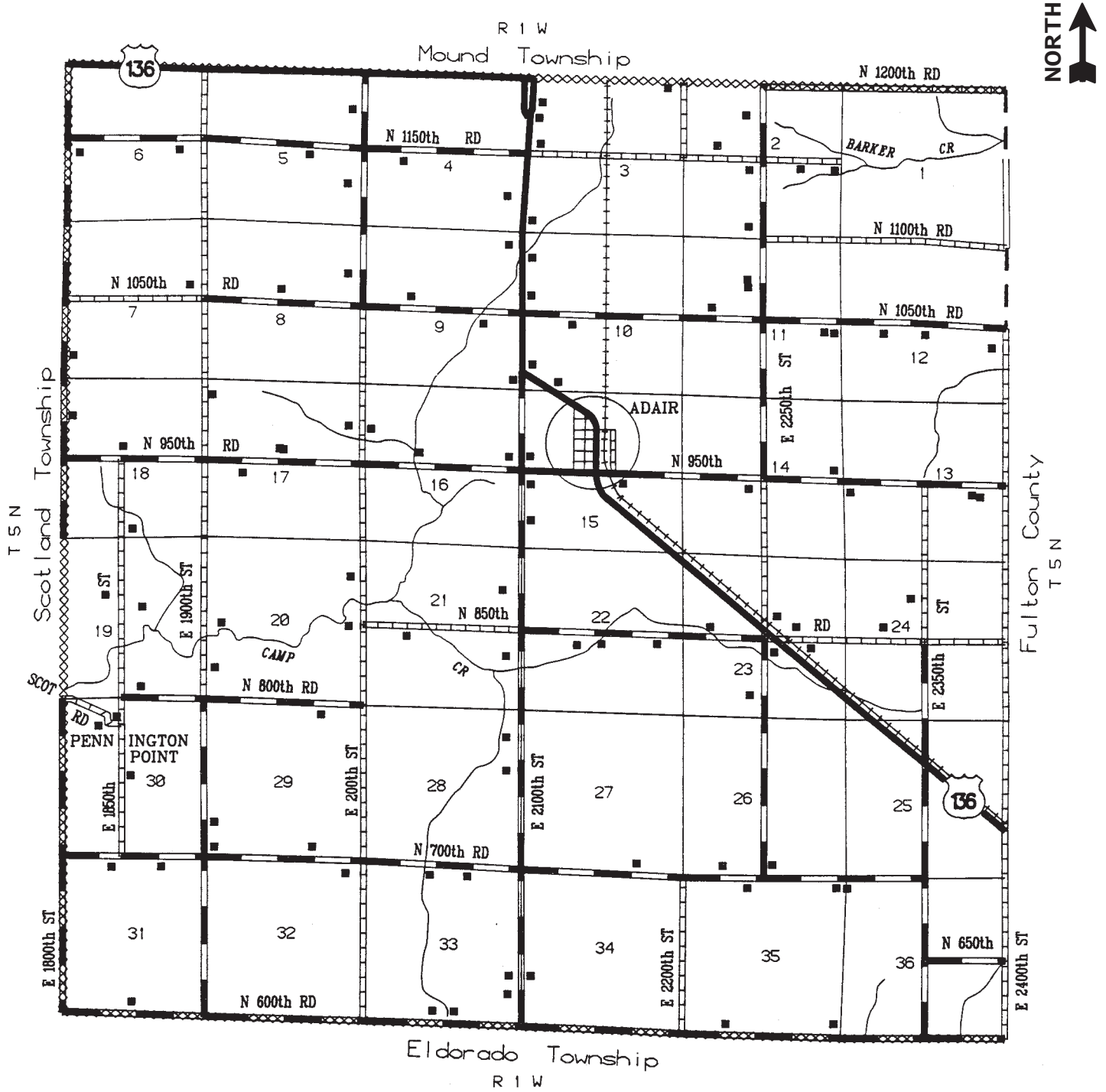

# Prairie City Township

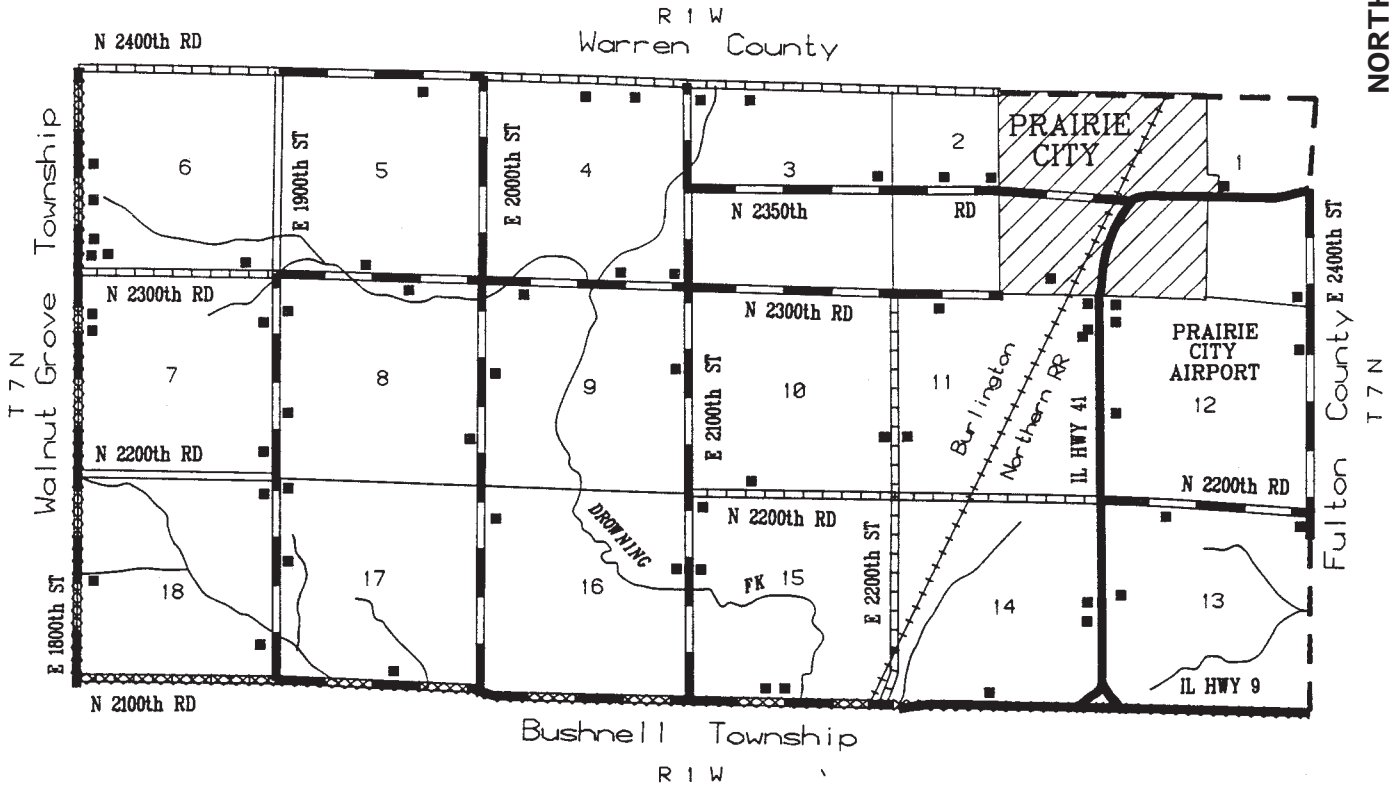

# Sciota Township

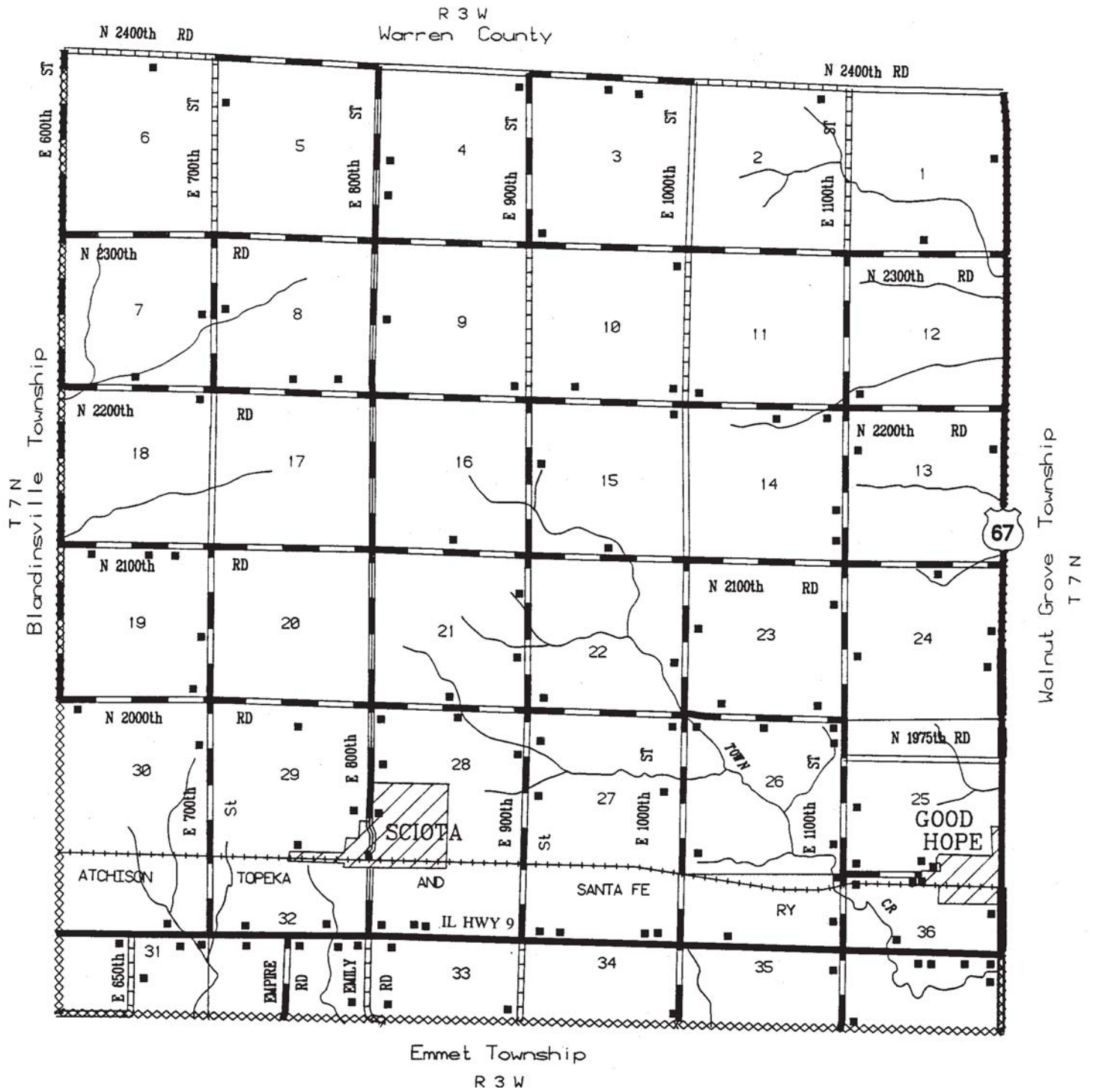

# Scotland Township

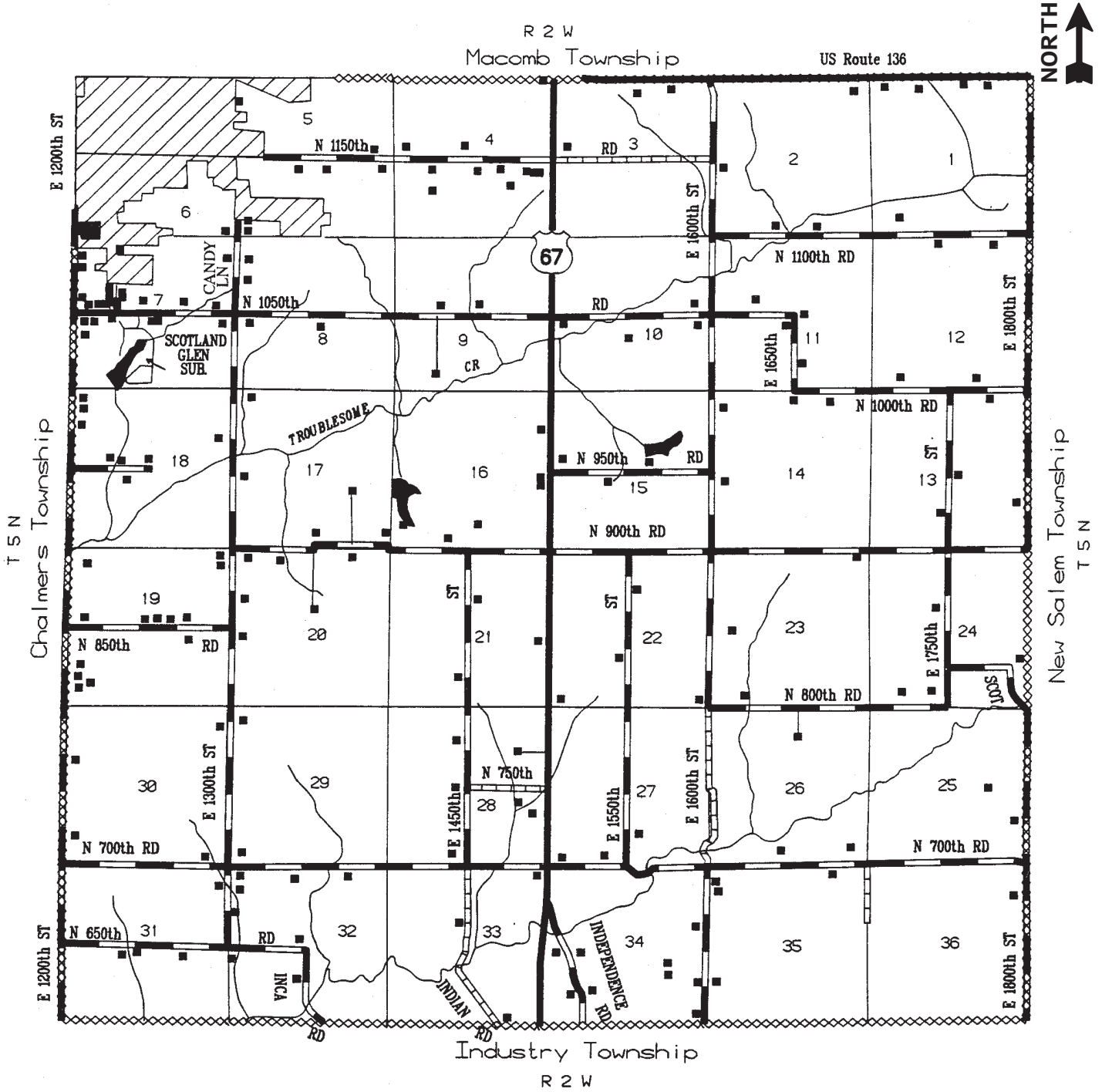

# Tennessee Township

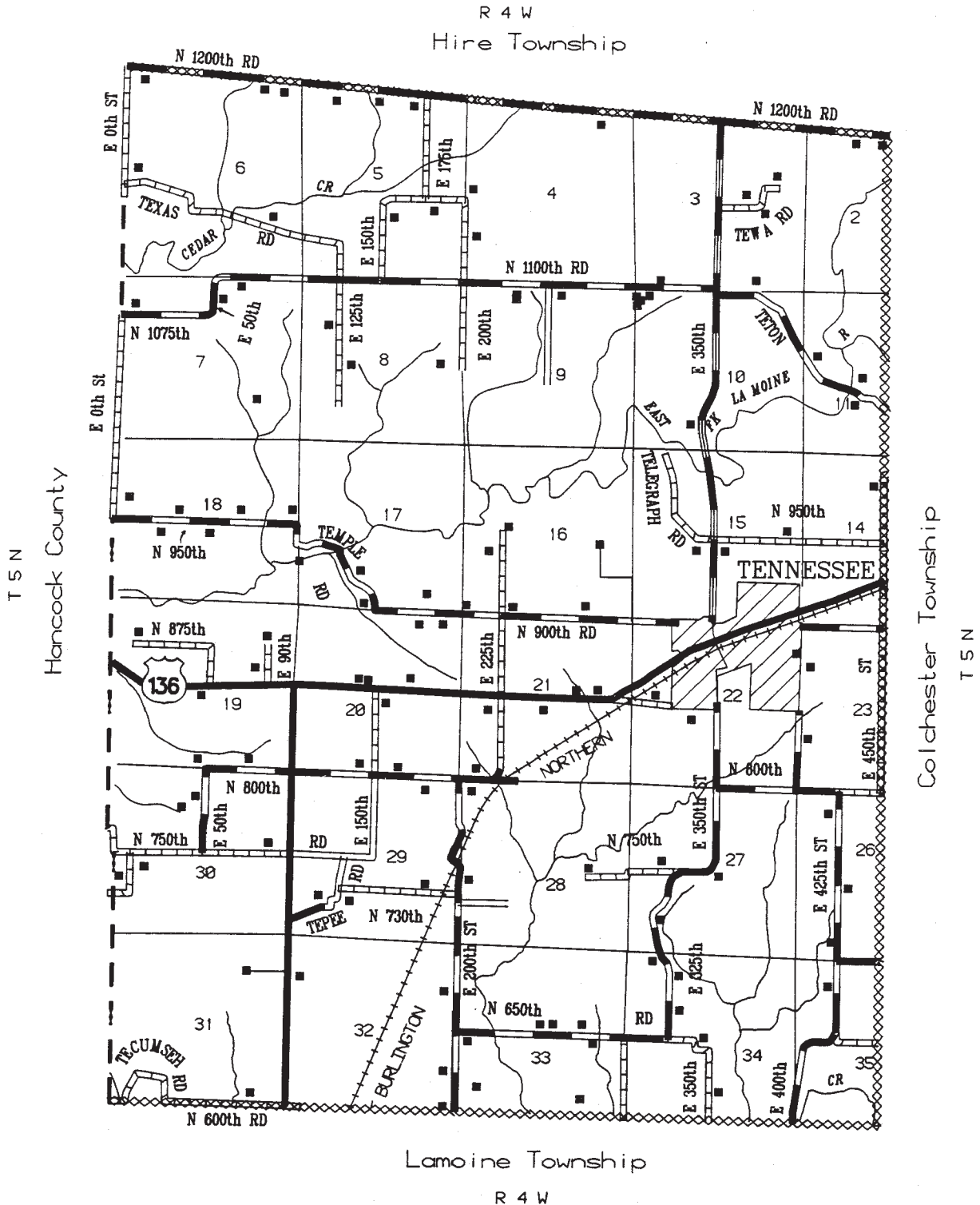

# Walnut Grove Township

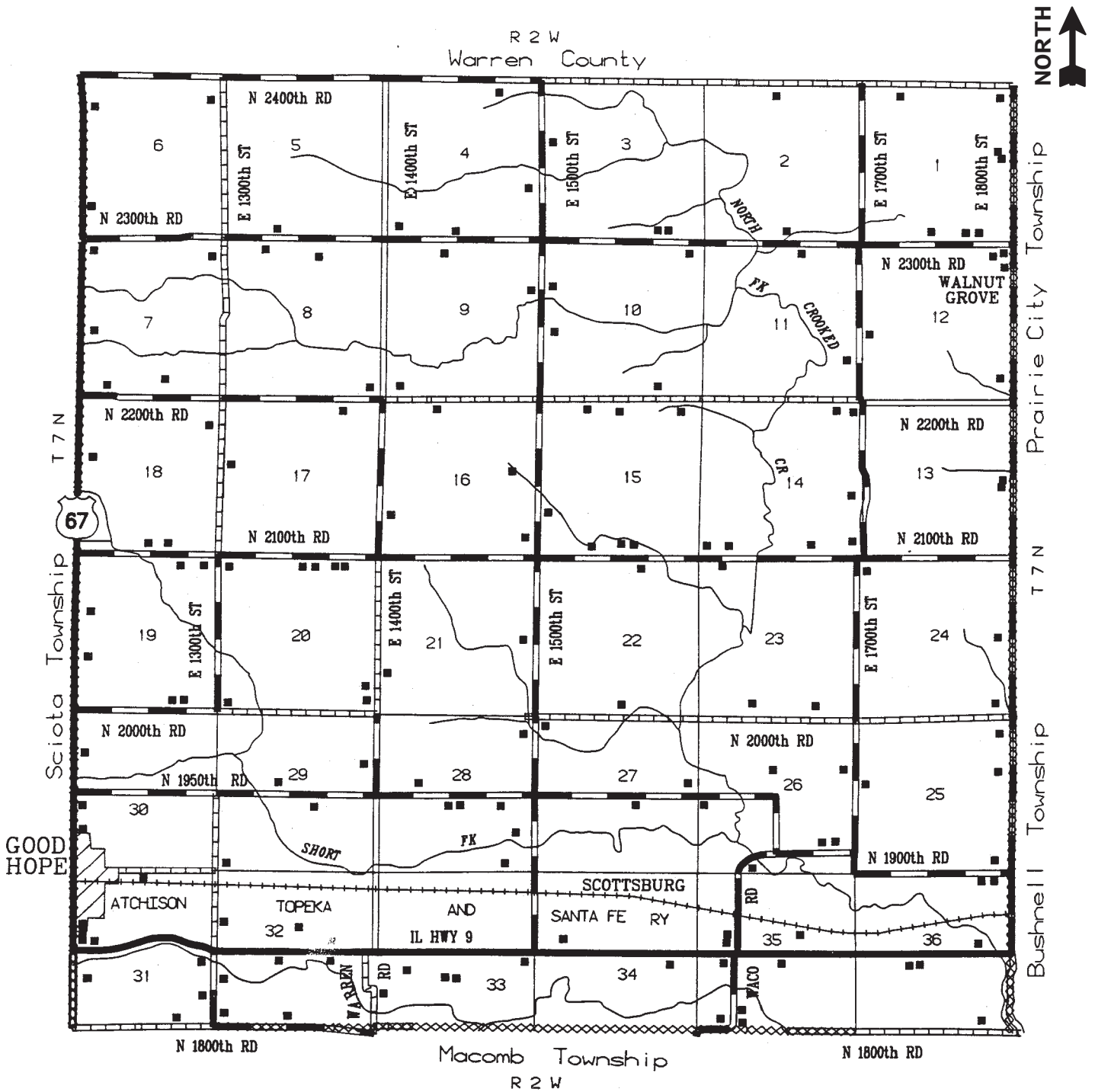

# Adair

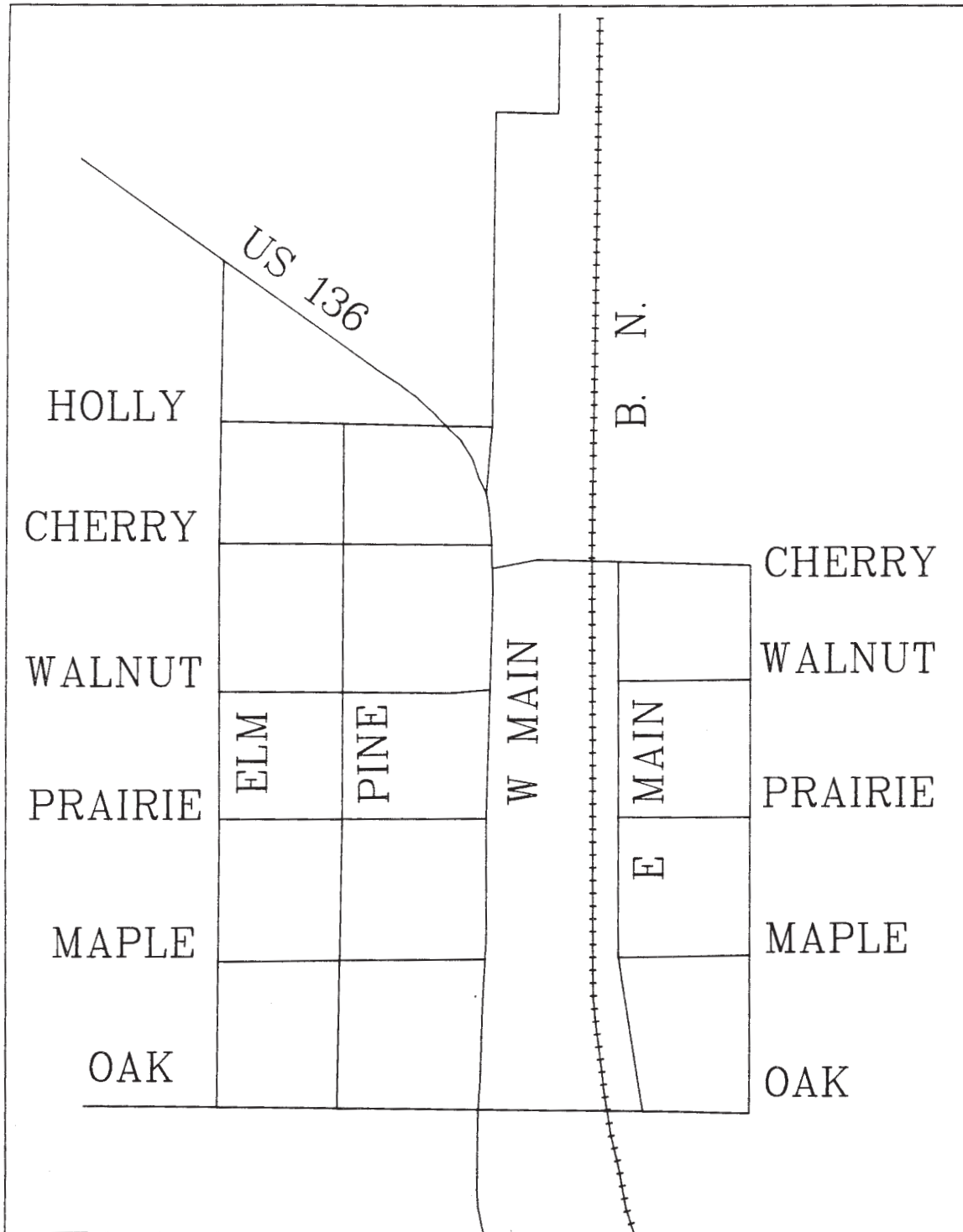

# Bardolph

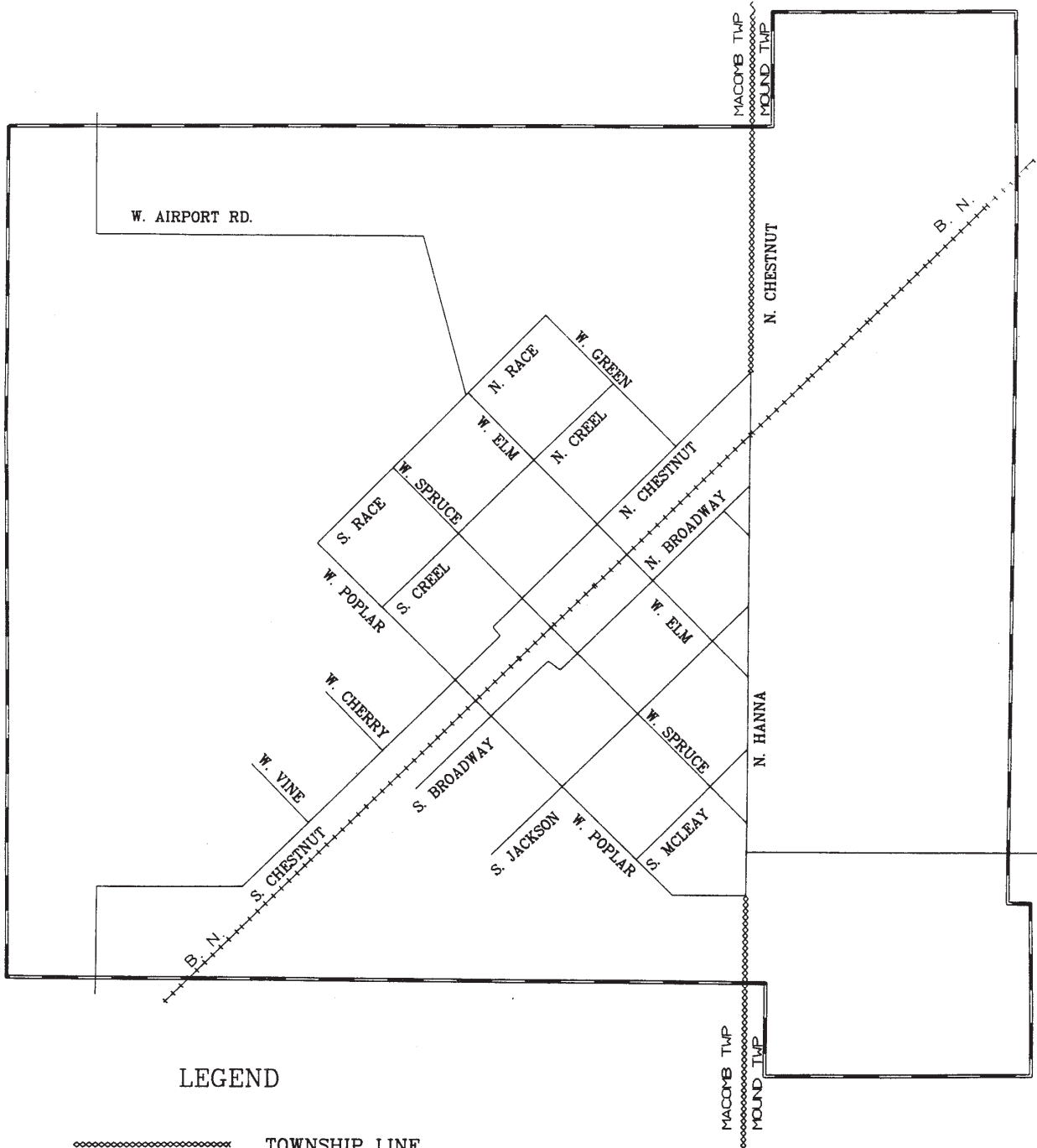

## LEGEND

- TOWNSHIP LINE
- CORPORATE LINE

## SCALE



# Blandinsville

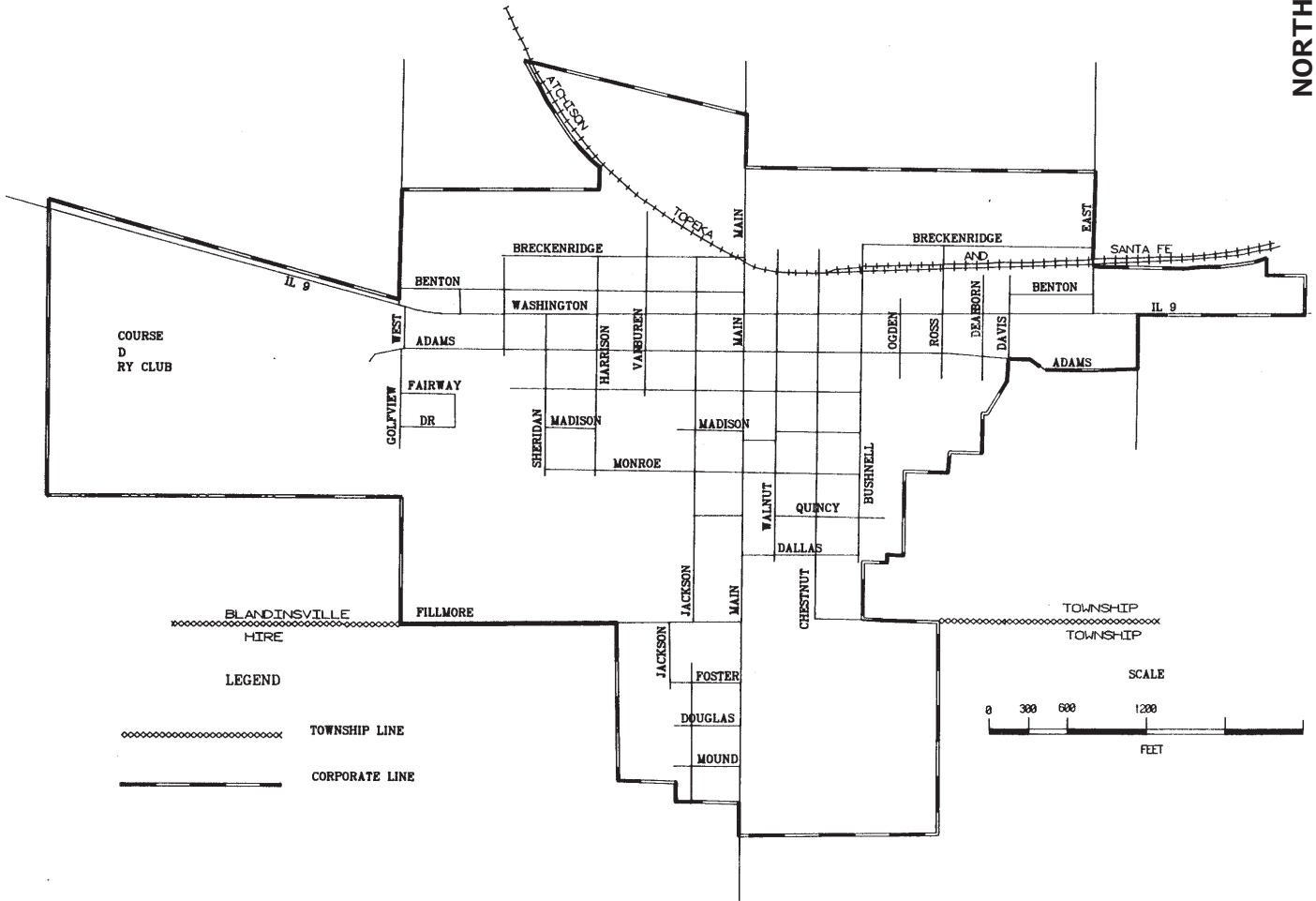

# Bushnell

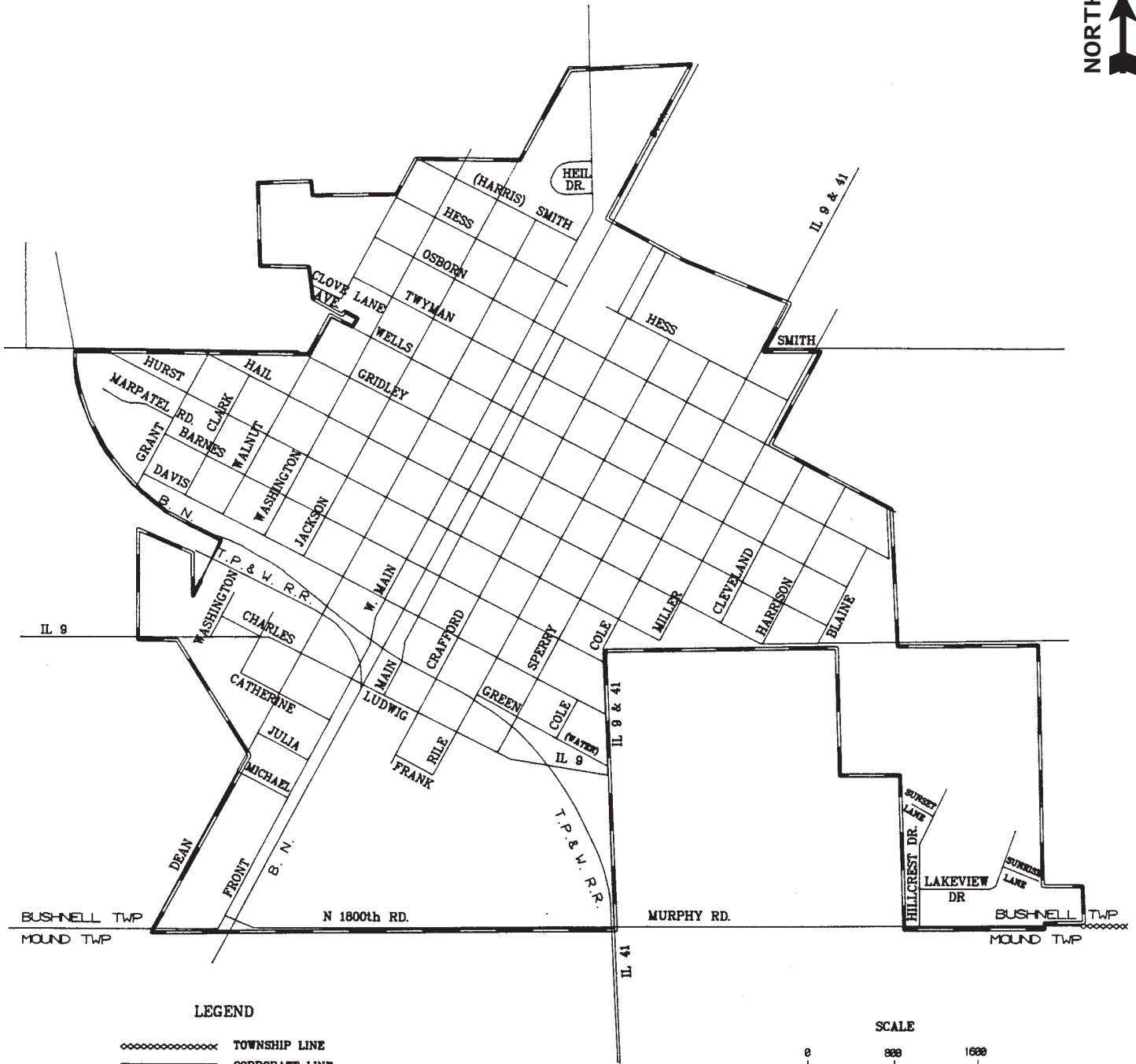



# Good Hope

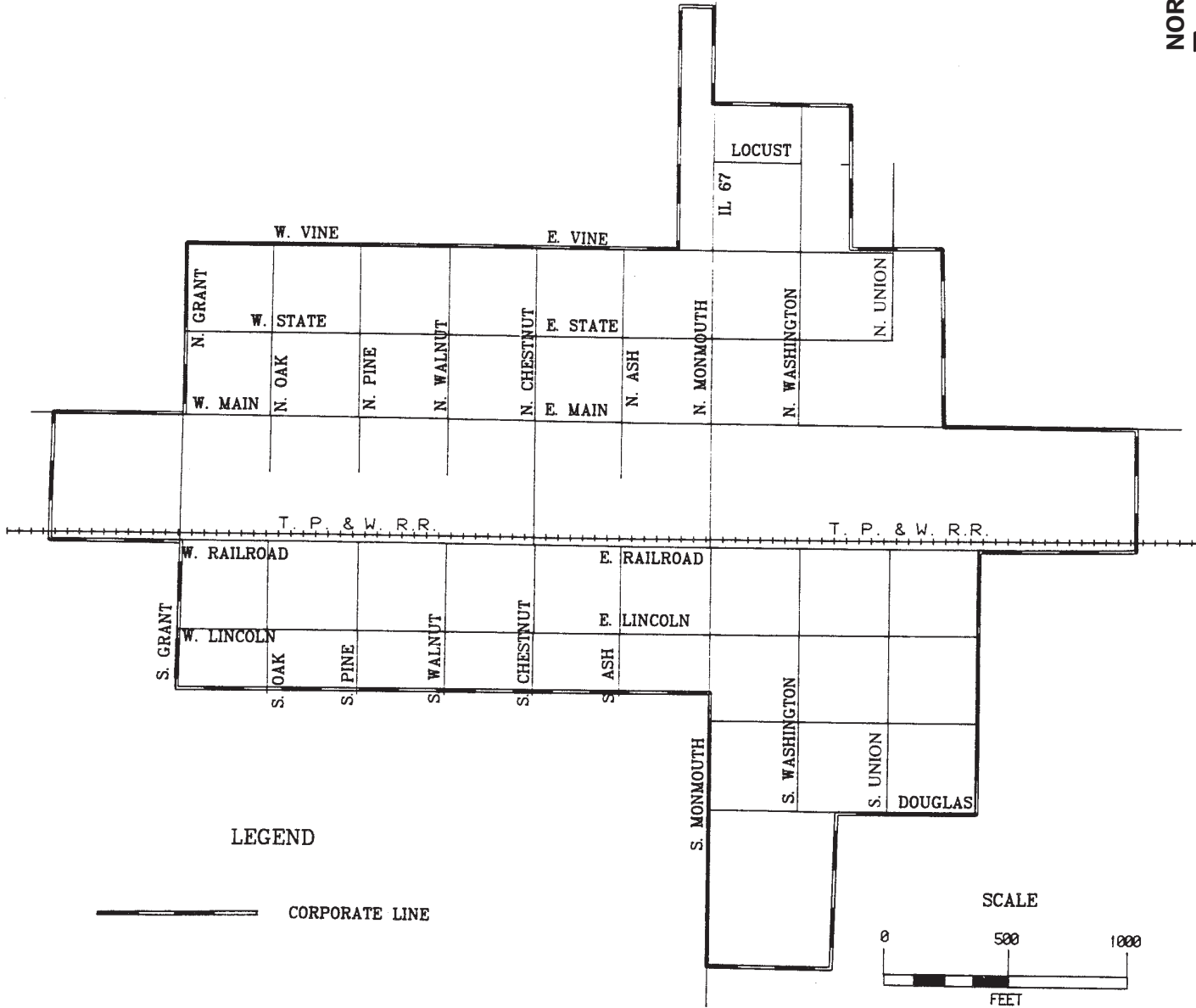

# Industry

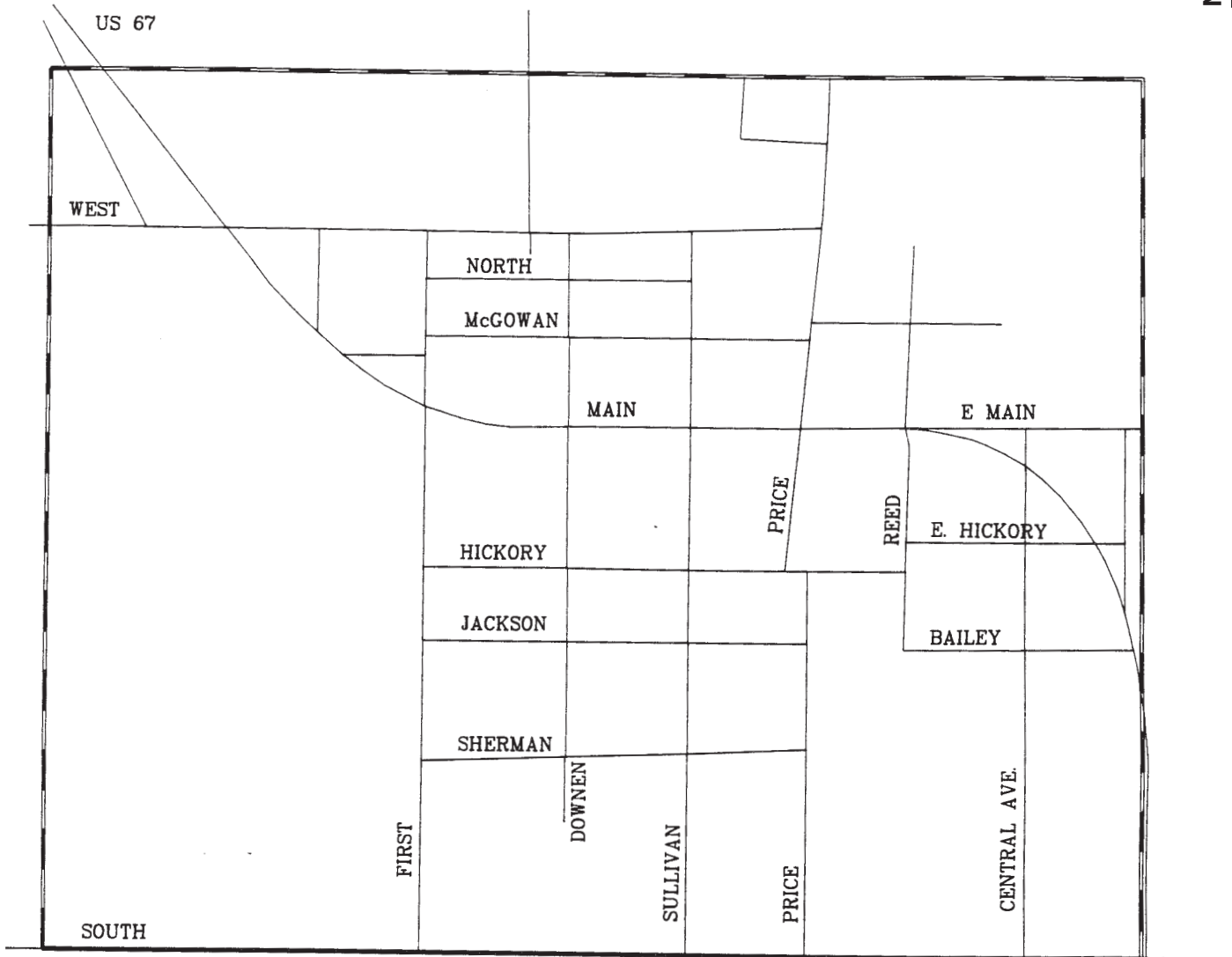

## LEGEND

 CORPORATE LINE

## SCALE

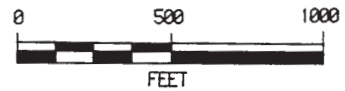

US 67

# Macomb

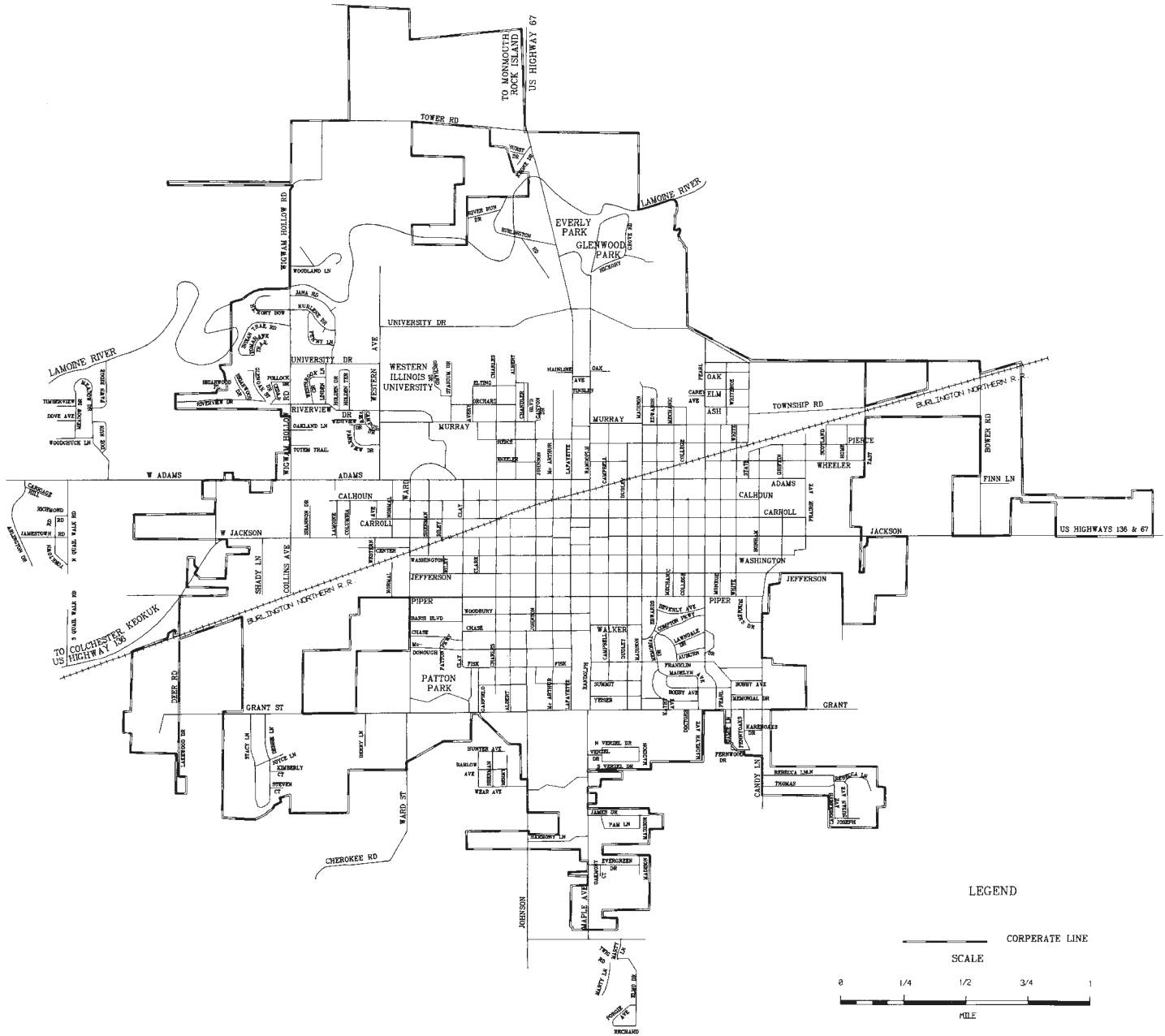

# Macomb Spring View Hills Subdivision

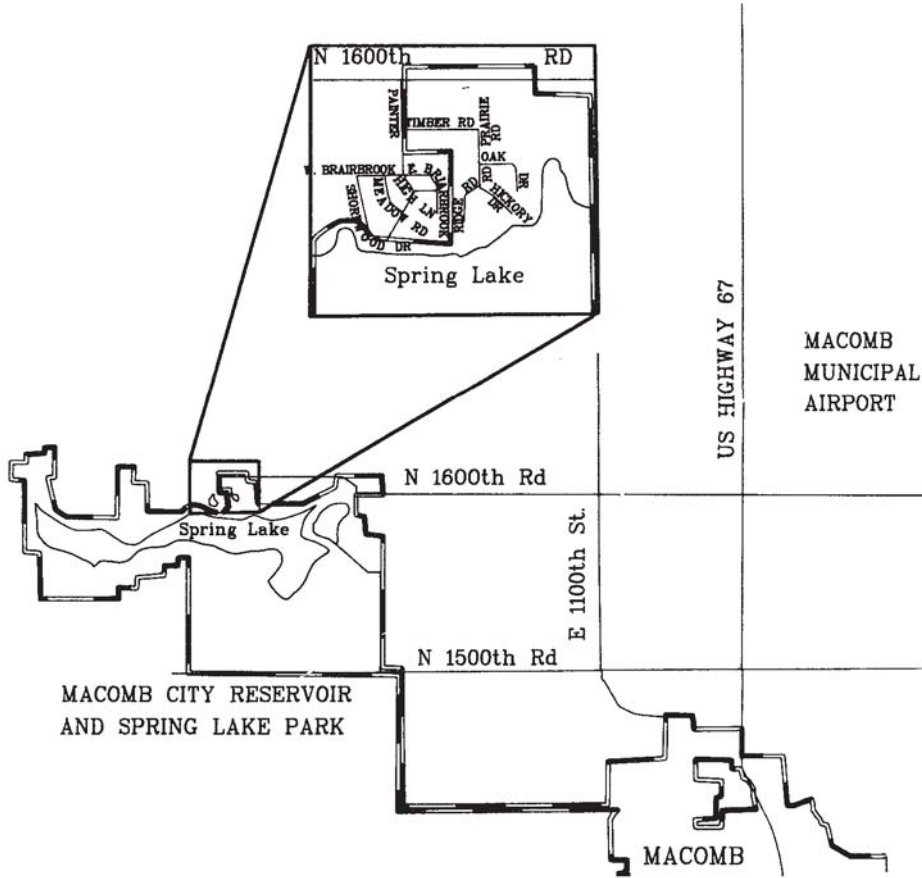

# Macomb WIU Campus

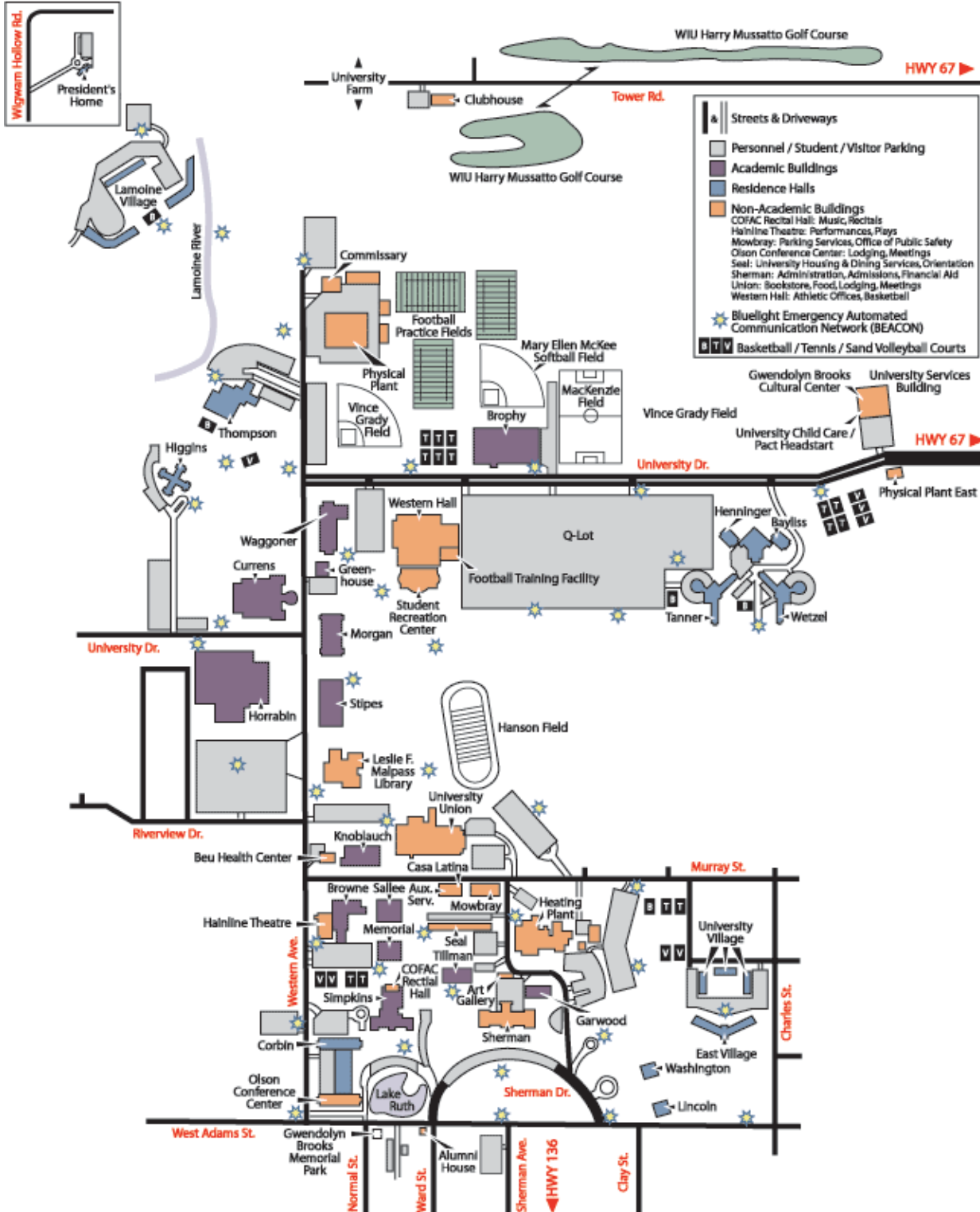

# Prairie City

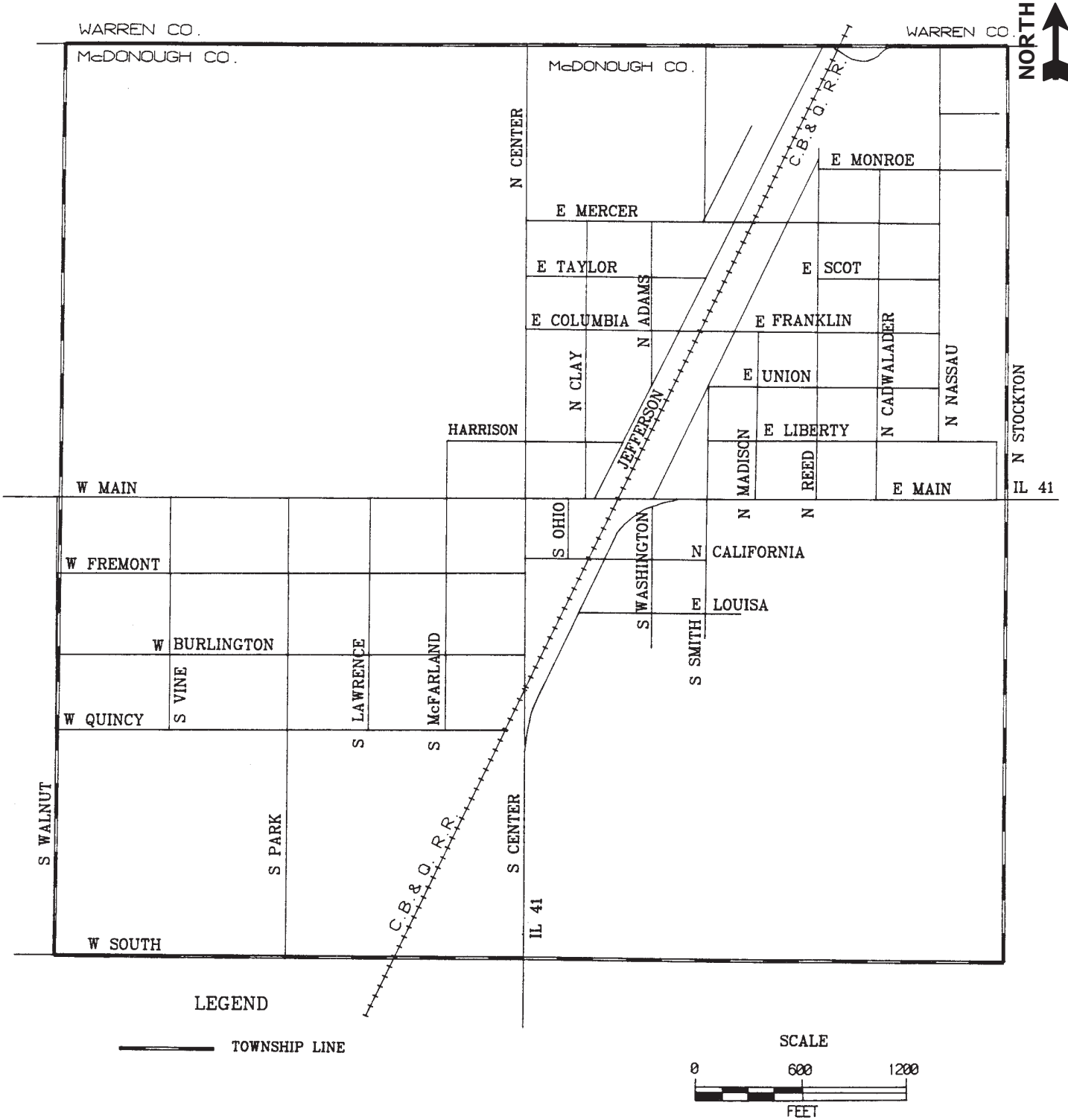

# Sciota

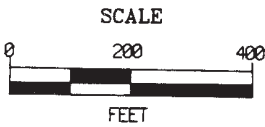
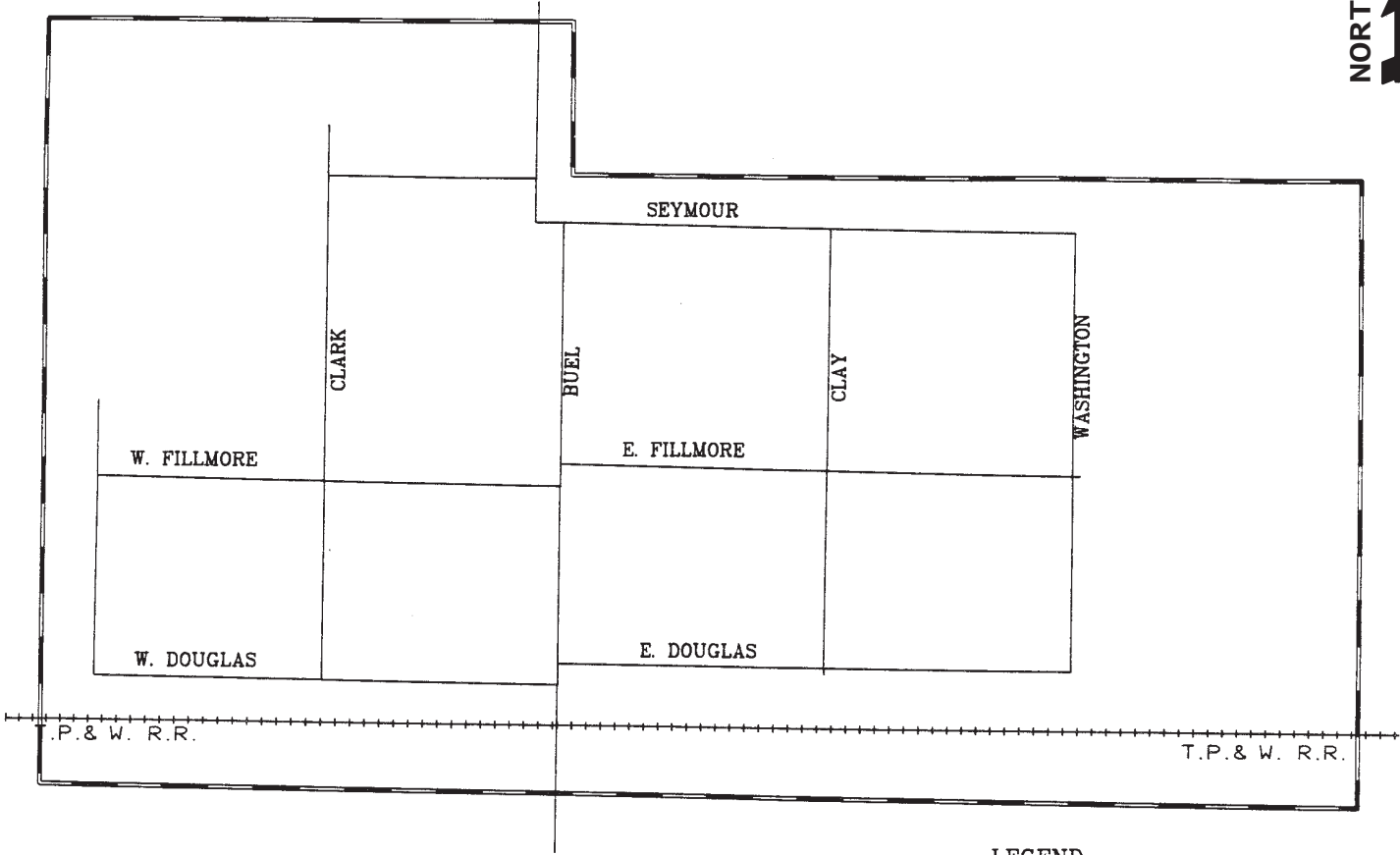

# Tennessee

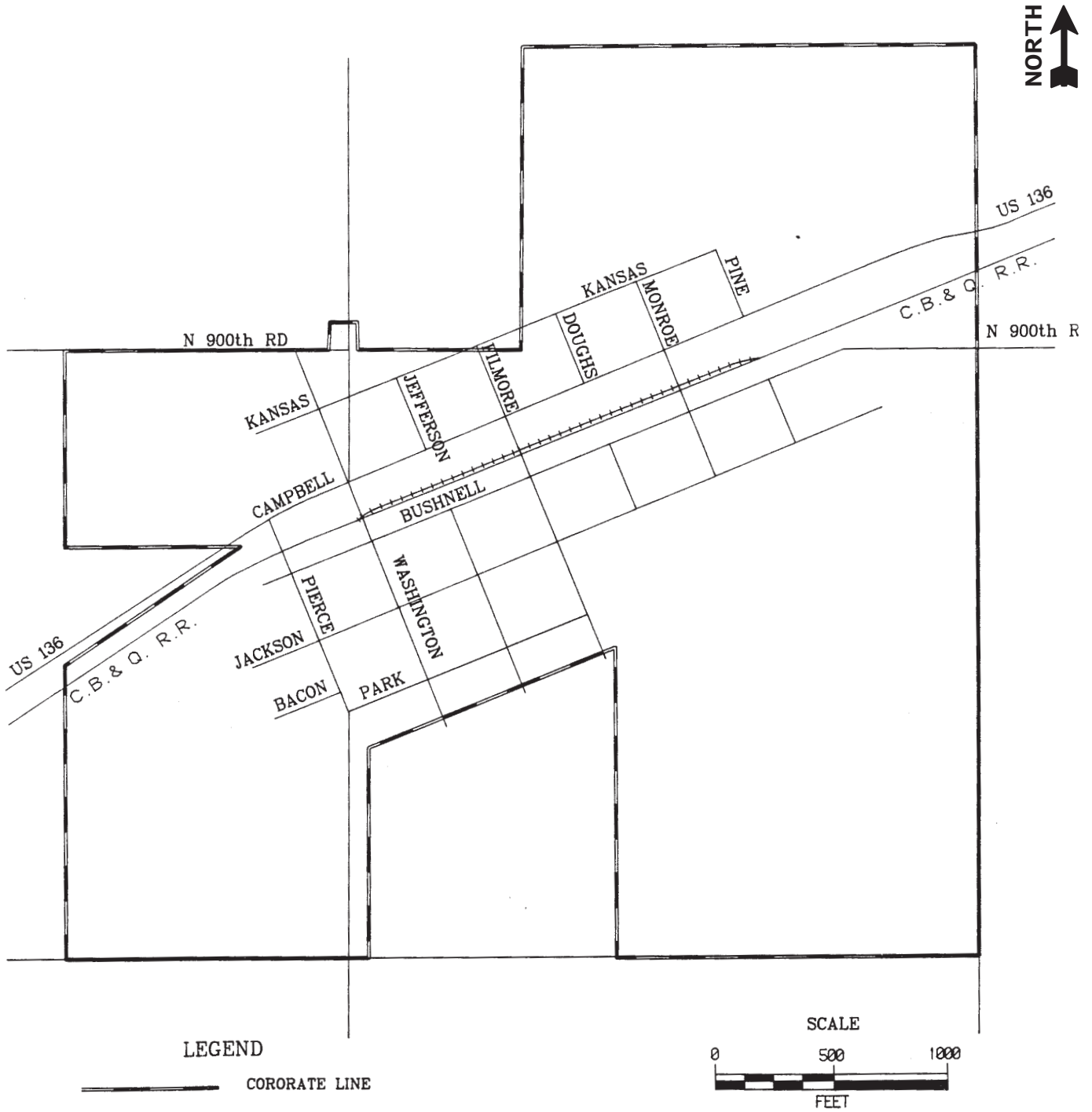

# Emmet Township Subdivisions

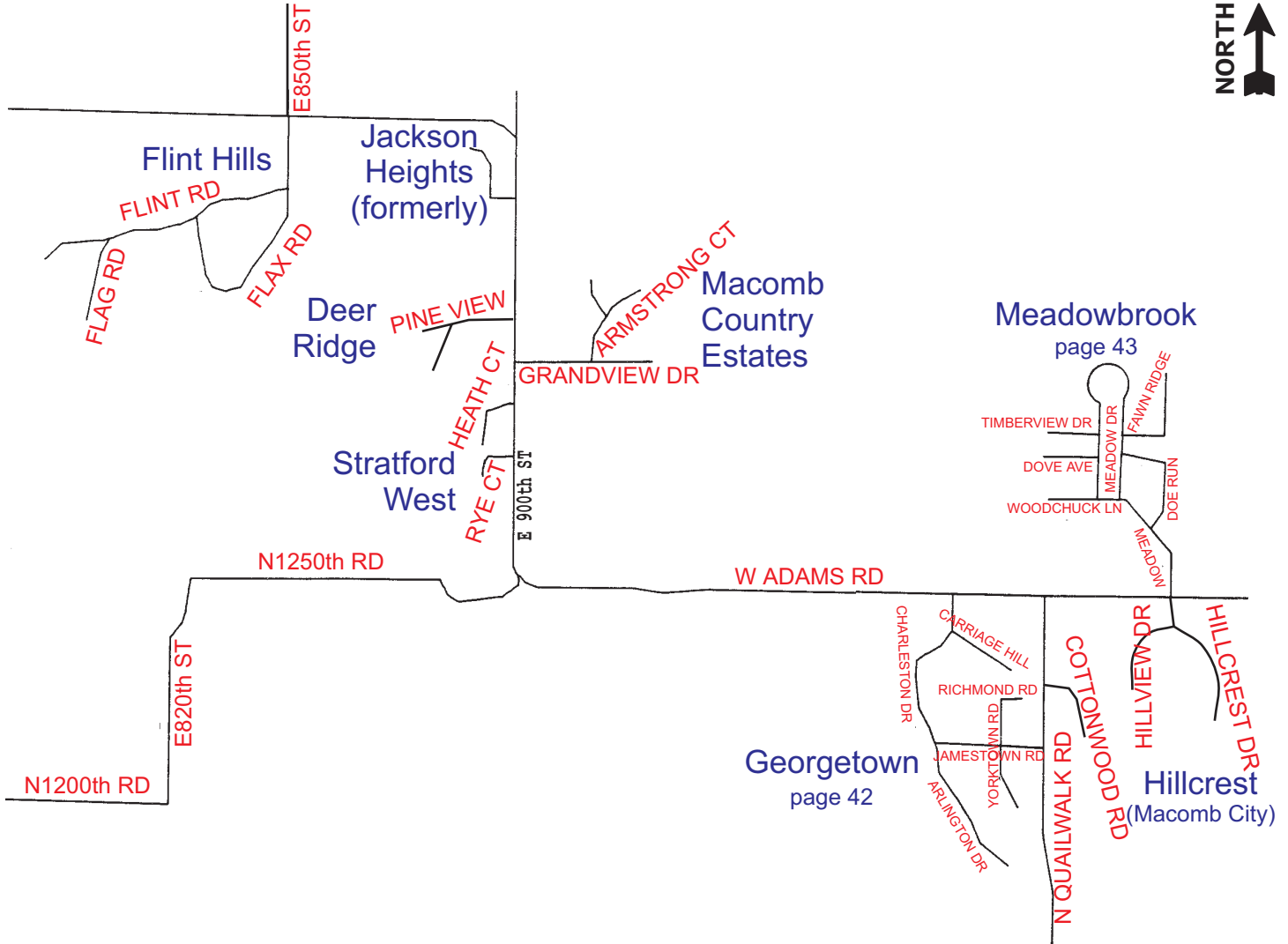

# Georgetown Subdivision

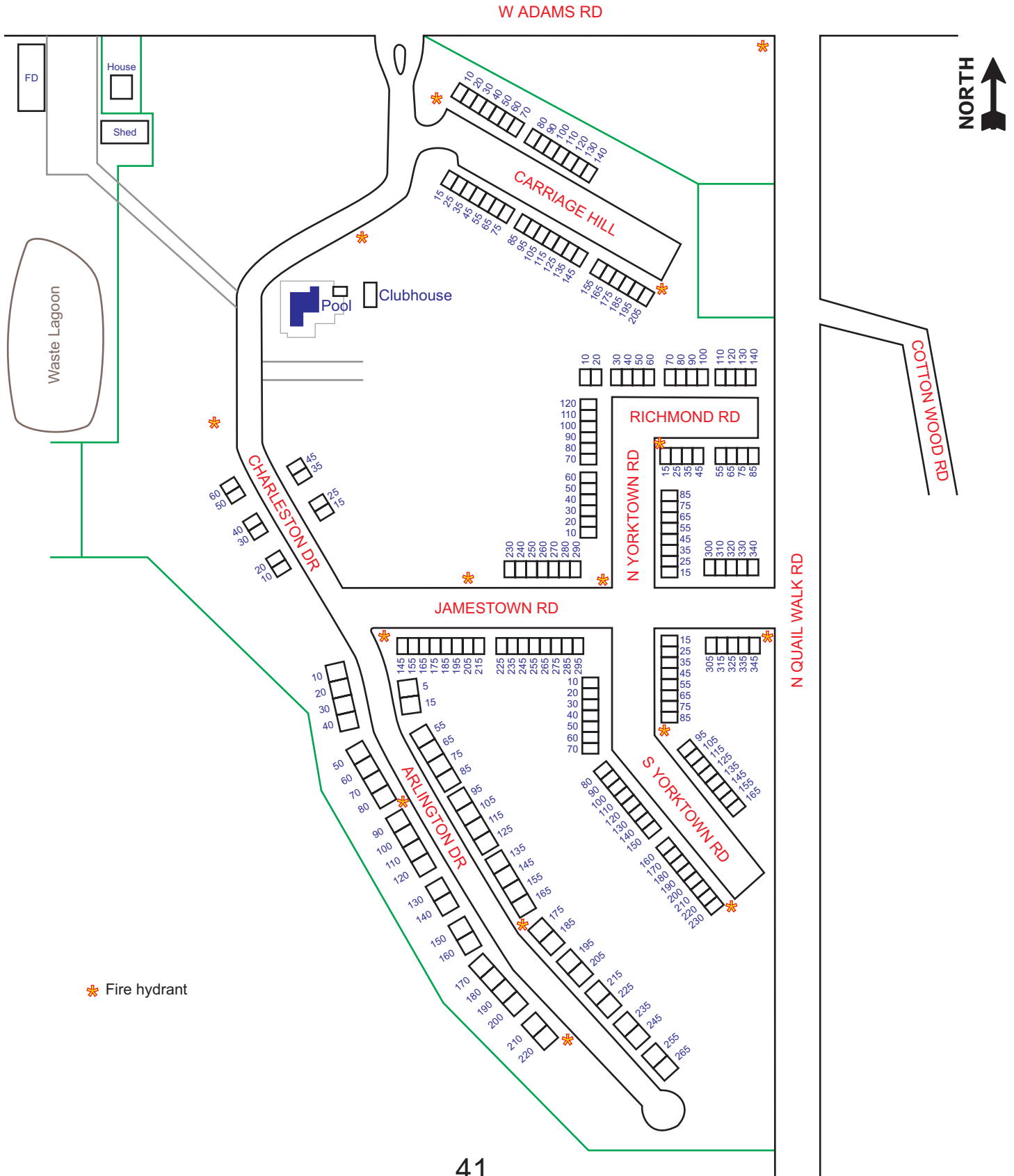

\* Fire hydrant



# Scotland Glen Subdivision

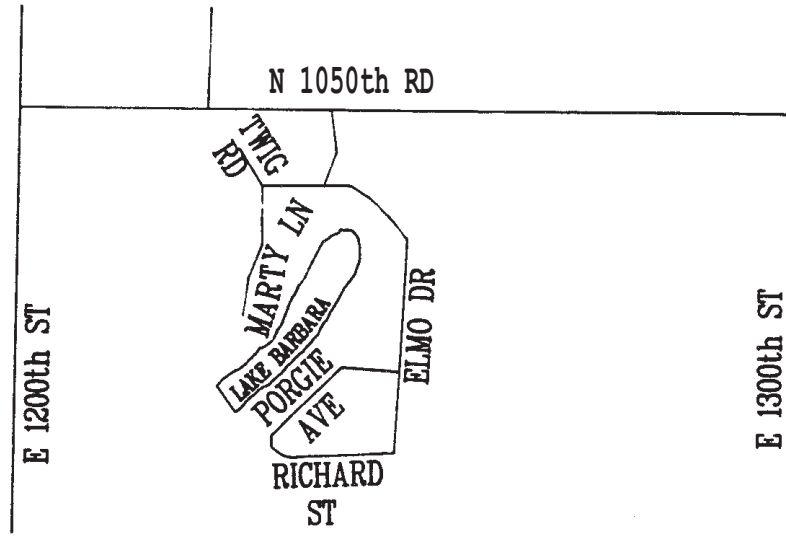

Scotland Glen

